



VIA FEDERAL EXPRESS

September 28, 2018

File No. 03-0122-01

Program Manager
Clean Water Program
PA Department of Environmental Protection
Southeast Regional Office
2 East Main Street
Norristown, PA 19401

Reference: NPDES MS4 Permit No. PAG 130036
NPDES Phase II MS4 Annual Report
Report Period – March 16, 2016 through June 30, 2018
Ambler Borough, Montgomery County

Dear Sir or Madam:

On behalf of Ambler Borough, Montgomery County, please find enclosed one copy of the above-referenced report and appurtenant information.

Please feel free to contact me with any questions regarding the enclosed information.

Sincerely,

A handwritten signature in blue ink that reads 'James P. Dougherty'.

James P. Dougherty, P.E.
Senior Project Manager
Gilmore & Associates, Inc.

A handwritten signature in black ink that reads 'Steve Walsh'.

Steve Walsh, P.E.
Project Manager
Gilmore & Associates, Inc.

JPD/SW/sl

Enclosures: As Referenced

cc: Mary Aversa, Manager – Ambler Borough (w/enc.)



ANNUAL MUNICIPAL SEPARATE STORM SEWER SYSTEM (MS4) STATUS REPORT

FOR THE PERIOD March 16, 2016 **TO JUNE 30,** 2018

GENERAL INFORMATION					
Permittee Name:	Borough of Ambler	NPDES Permit No.:	PAG130036		
Mailing Address:	131 Rosemary Avenue	Effective Date:	March 16, 2018		
City, State, Zip:	Ambler, PA 19002	Expiration Date:	March 15, 2023		
MS4 Contact Person:	Mary Aversa	Renewal Due Date:	September 16, 2022		
Title:	Borough Manager	Municipality:	Borough of Ambler		
Phone:	215 646-1000 ext. 8	County:	Montgomery		
Email:	maversa@borough.ambler.pa.us				
Co-Permittees (if applicable):					
Appendix(ces) that permittee is subject to (select all that apply):					
<input type="checkbox"/> Appendix A <input checked="" type="checkbox"/> Appendix B <input type="checkbox"/> Appendix C <input type="checkbox"/> Appendix D <input checked="" type="checkbox"/> Appendix E <input type="checkbox"/> Appendix F					
WATER QUALITY INFORMATION					
Are there any discharges to waters within the Chesapeake Bay Watershed? <input type="checkbox"/> Yes <input checked="" type="checkbox"/> No					
Identify all surface waters that receive stormwater discharges from the permittee's MS4 and provide the requested information (see instructions).					
Receiving Water Name	Ch. 93 Class.	Impaired?	Cause(s)	TMDL?	WLA?
Wissahickon Creek	TSF, MF	Y	Water/Flow Variability (4c), Pathogens	Y	Y

GENERAL MINIMUM CONTROL MEASURE (MCM) INFORMATION

Have you completed all MCM activities required by the permit for this reporting period? Yes No

List the current entity responsible for implementing each MCM of your SWMP, along with contact name and phone number.

MCM	Entity Responsible	Contact Name	Phone
#1 Public Education and Outreach on Storm Water Impacts	Borough Manager	Mary Aversa	215 646-1000
#2 Public Involvement/Participation	Borough Manager	Mary Aversa	215 646-1000
#3 Illicit Discharge Detection and Elimination (IDD&E)	Borough Manager	Mary Aversa	215 646-1000
#4 Construction Site Storm Water Runoff Control	Borough Manager	Mary Aversa	215 646-1000
#5 Post-Construction Storm Water Management in New Development and Redevelopment	Borough Manager	Mary Aversa	215 646-1000
#6 Pollution Prevention / Good Housekeeping	Borough Manager	Mary Aversa	215 646-1000

MCM #1 – PUBLIC EDUCATION AND OUTREACH ON STORM WATER IMPACTS

BMP #1: Develop, implement and maintain a written Public Education and Outreach Program.

1. For new permittees only, has the written PEOP been developed and implemented within the first year of permit coverage?

Yes No

2. Date of latest annual review of PEOP: Summer 2018 Were updates made? Yes No

3. What were the plans and goals for public education and outreach for the reporting period?

To implement strategies in the PEOP previously submitted to the Department.

4. Did the MS4 achieve its goal(s) for the PEOP during the reporting period? Yes No

5. Identify specific plans and goals for public education and outreach for the upcoming year:

Strategies outlined in the PEOP will continue to be implemented. The Borough reviews the PEOP periodically in order to identify opportunities for improvement.

The Borough finds it effective to reach the public with newsletters, through the Ambler Environmental Action Committee (EAC), and through the website. The website is continually reviewed and updated as necessary.

BMP #2: Develop and maintain lists of target audience groups present within the areas served by your MS4.

1. For new permittees only, have the target audience lists been developed and implemented within the first year of permit coverage?

Yes No

2. Date of latest annual review of target audience lists: Summer 2018 Were updates made? Yes No

BMP #3: Annually publish at least one educational item on your Stormwater Management Program.

1. For new permittees only, were stormwater educational and informational items produced and published in print and/or on the Internet within the first year of permit coverage?
 Yes No
2. Date of latest annual review of educational materials: Summer 2018 Were updates made? Yes No
3. Do you have a municipal website? Yes No (URL:
<http://boroughofambler.com/>)

If Yes, what MS4-related material does it contain?

The website provides quick reference material for several BMPs that homeowners can install on their properties. It provides links to EPA websites that provide information on BMPs, MS4, outreach materials, etc. A link to the Borough's EAC can be found on the website. The six minimum control measures for the Borough can also be found on the website.

4. Describe any other method(s) used during the reporting period to provide information on stormwater to the public:
Newsletters are issued at least twice per year to the community at large. Stormwater is discussed at public meetings and an update is provided annually. Additionally, the EAC goes out into the community and holds events such as EarthFest and rain garden tutorials.
5. Identify specific plans for the publication of stormwater materials for the upcoming year:
The website will continue to be updated regularly with materials useful to the residents of the Borough of Doylestown. In addition to being posted on the website, newsletters will be emailed to interested parties and be made available at Borough Hall.

BMP #4: Distribute stormwater educational materials to the target audiences.

Identify the two additional methods of distributing stormwater educational materials during the previous reporting period (e.g., displays, posters, signs, pamphlets, booklets, brochures, radio, local cable TV, newspaper articles, other advertisements, bill stuffers, posters, presentations, conferences, meetings, fact sheets, giveaways, or storm drain stenciling).

In addition to the Borough's website, the Borough issues newsletters, holds public meetings, and provides how to install BMP instructions throughout the year. The EAC is also involved in numerous outreach programs.

MCM #1 Comments:

MCM #2 – PUBLIC INVOLVEMENT/PARTICIPATION

BMP #1: Develop, implement and maintain a written Public Involvement and Participation Program (PIPP)

1. For new permittees only, was the PIPP developed and implemented within one year of permit coverage?
 Yes No
2. Date of latest annual review of PIPP: Summer 2018 Were updates made? Yes No

BMP #2: Advertise to the public and solicit public input on ordinances, SOPs, Pollutant Reduction Plans (PRPs) (if applicable) and TMDL Plans (if applicable), including modifications thereto, prior to adoption or submission to DEP:

1. Was an MS4-related ordinance, SOP, PRP or TMDL Plan developed during the reporting period? Yes No
2. If Yes, describe how you advertised the draft document(s) and how you provided opportunities for public review, input and feedback:

The PRP was advertised in the local paper and on the Borough's website (See Attachment 2).
3. If an ordinance, SOP or plan was developed or amended during the reporting period, provide the following information:

Ordinance / SOP / Plan Name	Date of Public Notice	Date of Public Hearing	Date Enacted or Submitted to DEP
PRP	July 30, 2017	August 15, 2017	September 13, 2017

BMP #3: Regularly solicit public involvement and participation from the target audience groups using available distribution and outreach methods.

1. At least one public meeting or other MS4 event must be held during the 5-year permit coverage period to solicit participation and feedback from target audience groups. Was this meeting or event held during the reporting period?

Yes No If Yes, Date of Meeting or Event: August 15, 2017

2. Report instances of cooperation and participation in MS4 activities; presentations the permittee made to local watershed and conservation organizations; and similar instances of participation or coordination with organizations in the community.

EarthFest 2018 (See Attachment 3), Wissahickon Clean Water Partnership

3. Report activities in which members of the public assisted or participated in the meetings and in the implementation of the SWMP, including education activities or efforts such as cleanups, monitoring, storm drain stenciling, or others.

EarthFest 2018 (See Attachment 3), Ambler's 100 Rain Gardens Campaign (See Attachment 3), Help Make Ambler a Shade Better (See Attachment 3)

MCM #2 Comments:

MCM #3 – ILLICIT DISCHARGE DETECTION AND ELIMINATION (IDD&E)

BMP #1: Develop and implement a written program for the detection, elimination, and prevention of illicit discharges into the regulated small MS4.

1. For new permittees only, was the written IDD&E program developed within one year of permit coverage?

Yes No

2. Date of latest annual review of IDD&E program: Summer 2018 Were updates made? Yes No

BMP #2: Develop and maintain map(s) that show permittee and urbanized area boundaries, the location of all outfalls and, if applicable, observation points, and the locations and names of all surface waters that receive discharges from those outfalls. Outfalls and observation points shall be numbered on the map(s).

1. Have you completed a map(s) that includes all components of BMP #2? Yes No

If Yes and you are a new permittee and have not submitted the map(s) previously, attach the map(s) to this report.

If No, date by which permittee expects map(s) to be completed:

2. Date of last update or revision to map(s): May 2016

3. Total No. of Outfalls in MS4: 34 Total No. of Outfalls Mapped: 34

4. Total No. of Observation Points: 0 Total No. of Observation Points Mapped: 0

5. During the reporting period, have you identified any existing outfalls that have not been previously reported to DEP in an NOI, application or annual report, or are any new MS4 outfalls proposed for the next reporting period?

Yes No If Yes, select: Existing Outfall(s) Identified New Outfall(s) Proposed

BMP #3: In conjunction with the map(s) created under BMP #2 (either on the same map or on a different map), the permittee shall develop and maintain map(s) that show the entire storm sewer collection system within the permittee's jurisdiction that are owned or operated by the permittee (including roads, inlets, piping, swales, catch basins, channels, and any other components of the storm sewer collection system), including privately-owned components of the collection system where conveyances or BMPs on private property receive stormwater flows from upstream publicly-owned components.

1. Have you completed a map(s) that includes all components of BMP #3? Yes No

If Yes and you are a new permittee and have not submitted the map(s) previously, attach the map(s) to this report.

If No, date by which permittee expects map(s) to be completed:

2. If Yes to #1, is the map(s) on the same map(s) as for outfalls and receiving waters? Yes No

3. Date of last update or revision to map(s): May 2016

BMP #4: Conduct dry weather screenings of MS4 outfalls to evaluate the presence of illicit discharges. If any illicit discharges are present, the permittee shall identify the source(s) and take appropriate actions to remove or correct any illicit discharges. The permittee shall also respond to reports received from the public or other agencies of suspected or confirmed illicit discharges associated with the storm sewer system, as well as take enforcement action as necessary. The permittee shall immediately report to DEP illicit discharges that would endanger users downstream from the discharge, or would otherwise result in pollution or create a danger of pollution or would damage property.

For new permittees, all identified outfalls (and if applicable observation points) must be screened during dry weather at least twice within the 5-year period following permit coverage. For existing permittees, all identified outfalls (and if applicable observation points) must be screen during dry weather at least once within the 5-year period following permit coverage and, for areas where past problems have been reported or known sources of dry weather flows occur on a continual basis, outfalls must be screened annually during each year of permit coverage.

1. How many unique outfalls (and if applicable observation points) were screened during the reporting period? 26

2. Indicate the percentage of all outfalls screened in the past five years. 77%

3. Indicate the percent of outfalls screened during the reporting period that revealed dry weather flows: 12%

4. Did any dry weather flows reveal color, turbidity, sheen, odor, floating or submerged solids? Yes No

5. If Yes for #4, attach all sample results to this report with a map identifying the sample location. Explain the corrective action(s) taken in the attachment.

6. Do you use the MS4 Outfall Field Screening Report form (3800-FM-BCW0521) provided in the permit?

Yes No

If No, attach a copy of your screening report form.

BMP #5: Enact a Stormwater Management Ordinance or SOP to implement and enforce a stormwater management program that includes prohibition of non-stormwater discharges to the regulated small MS4.

1. Do you have an ordinance (municipal) or SOP or other mechanism (non-municipal) that prohibits non-stormwater discharges? Yes No

If Yes, indicate the date of the ordinance or SOP: July 2012

2. If Yes to #1, is the ordinance or SOP consistent with DEP's 2022 Model Stormwater Management Ordinance (3800-PM-BCW0100j) with respect to authorized non-stormwater discharges? Yes No

If Yes to #2 and the ordinance or SOP has not been submitted to DEP previously, attach the ordinance or SOP.

3. Were there any violations of the ordinance or SOP during the reporting period? Yes No

If Yes to #3, complete the table below (attach additional sheets as necessary).

Violation Date	Nature of Violation	Responsible Party	Enforcement Taken

4. Did you approve any waiver or variance during the reporting period that allowed an exception to non-stormwater discharge provisions of an ordinance or SOP? Yes No

If Yes to #4, identify the entity that received the waiver or variance and the type of non-stormwater discharge approved.

BMP #6: Provide educational outreach to public employees, business owners and employees, property owners, the general public and elected officials (i.e., target audiences) about the program to detect and eliminate illicit discharges.

1. Was IDD&E-related information distributed to public employees, businesses, and the general public during the reporting period? Yes No

If Yes, what was distributed? The information published in the Borough Newsletter (Hometown News) and provided on the Borough website discusses the sources and impacts of Illicit Discharges. All target audience groups are encouraged to report illicit discharges by calling Borough Hall directly or through the Borough Department of Public Works system.

2. Is there a well-publicized method for employees, businesses and the public to report stormwater pollution incidents?

Yes No

3. Do you maintain documentation of all responses, action taken, and the time required to take action? Yes No

MCM #3 Comments:

MCM #4 – CONSTRUCTION SITE STORMWATER RUNOFF CONTROL

Are you relying on PA's statewide program for stormwater associated with construction activities to satisfy this MCM?

Yes No

(If Yes, respond to questions for BMP Nos. 1, 2 and 3 only in this section. If No, respond to questions for all BMPs in this section)

BMP #1: The permittee may not issue a building or other permit or final approval to those proposing or conducting earth disturbance activities requiring an NPDES permit unless the party proposing the earth disturbance has valid NPDES Permit coverage (i.e., not expired) under 25 Pa. Code Chapter 102.

During the reporting period, did you comply with 25 Pa. Code § 102.43 (relating to withholding building or other permits or approvals until DEP or a county conservation district (CCD) has approved NPDES permit coverage)?

Yes No Not Applicable (no building permit applications received)

BMP #2: A municipality or county which issues building or other permits shall notify DEP or the applicable CCD within 5 days of the receipt of an application for a permit involving an earth disturbance activity consisting of one acre or more, in accordance with 25 Pa. Code § 102.42.

During the reporting period, did you comply with 25 Pa. Code § 102.42 (relating to notifying DEP/CCD within 5 days of receiving an application involving an earth disturbance activity of one acre or more)?

Yes No Not Applicable (no building permit applications received)

BMP #3: Enact, implement and enforce an ordinance or SOP to require the implementation and maintenance of E&S control BMPs, including sanctions for non-compliance, as applicable.

1. Do you have an ordinance (municipal) or SOP or other mechanism (non-municipal) that requires implementation and maintenance of E&S control BMPs? Yes No

If Yes, indicate the date of the ordinance or SOP: October 17, 2017; Ordinance ##1108

2. If Yes to #1, is the ordinance or SOP consistent with DEP's 2022 Model Stormwater Management Ordinance (3800-PM-BCW0100j)? Yes No

3. If Yes to #2 and the ordinance or SOP has not been submitted previously, attach a copy of the ordinance or SOP.

BMP #4: Review Erosion and Sediment (E&S) control plans to ensure that such plans adequately consider water quality impacts and meet regulatory requirements.

Specify the number of E&S Plans you reviewed during the reporting period: 0

BMP #5: Conduct inspections regarding installation and maintenance of E&S control measures during earth disturbance activities. Maintain records of site inspections, including dates and inspection results, in accordance with the record retention requirements in this permit.

Specify the number of E&S inspections you completed during the reporting period: Inspections occur during construction on a regular basis and generally before and after a storm event.

BMP #6: Conduct enforcement when installation and maintenance of E&S control measures during earth disturbance activities does not comply with permit and/or regulatory requirements.

Specify the number of enforcement actions you took during the reporting period for improper E&S: 0

BMP #7: Develop and implement requirements for construction site operators to control waste at construction sites that may cause adverse impacts to water quality. The permittee shall provide education on these requirements to construction site operators.

Specify the method(s) by which you are educating construction site operators on controlling waste at construction sites:

Pre-Construction Meetings are held with the MCCD prior to all new construction.

BMP #8: Develop and implement procedures for the receipt and consideration of public inquiries, concerns, and information submitted by the public to the permittee regarding local construction activities.

1. A tracking system has been established for receipt of public inquiries and complaints. Yes No

2. Specify the number of inquiries and complaints received during the reporting period: 0

MCM #4 Comments:



MCM #5 – POST-CONSTRUCTION STORM WATER MANAGEMENT IN NEW DEVELOPMENT AND REDEVELOPMENT

BMP #1: Enact, implement and enforce an ordinance or SOP to require post-construction stormwater management from new development and redevelopment projects, including sanctions for non-compliance.

1. Do you have an ordinance (municipal) or SOP or other mechanism (non-municipal) that requires implementation and maintenance of post-construction stormwater management (PCSM) BMPs? Yes No
If Yes, indicate the date of the ordinance or SOP: October 17, 2017; Ordinance ##1108
2. If Yes to #1, is the ordinance or SOP consistent with DEP's 2022 Model Stormwater Management Ordinance (3800-PM-BCW0100j)? Yes No
3. If Yes to #2 and the ordinance or SOP has not been submitted previously, attach a copy of the ordinance or SOP.

BMP #2: Develop and implement measures to encourage and expand the use of Low Impact Development (LID) in new development and redevelopment. Measures should also be included to encourage retrofitting LID into existing development. Enact ordinances consistent with LID practices and repeal sections of ordinances that conflict with LID practices.

1. Do you have an ordinance (municipal) or SOP or other mechanism (non-municipal) that encourages and expands the use of LID in new development and redevelopment? Yes No
If Yes, indicate the date of the ordinance or SOP: October 17, 2017; Ordinance ##1108
2. If Yes to #1, is the ordinance or SOP consistent with DEP's 2022 Model Stormwater Management Ordinance (3800-PM-BCW0100j)? Yes No
3. If Yes to #2 and the ordinance or SOP has not been submitted previously, attach a copy of the ordinance or SOP.

BMP #3: Ensure adequate O&M of all post-construction stormwater management BMPs that have been installed at development or redevelopment projects that disturb greater than or equal to one acre, including projects less than one acre that are part of a larger common plan of development or sale.

1. Do you have an inventory of all PCSM BMPs that were installed to meet requirements in NPDES Permits for Stormwater Discharges Associated with Construction Activities approved since March 10, 2003? Yes No
If Yes to #1, complete Table 1 on the next page.
2. Has proper O&M occurred during the reporting period for all PCSM BMPs? Yes No
3. If No to #2, explain what action(s) the permittee has taken or plans to take to ensure proper O&M.

If you are relying on PA's statewide program for stormwater associated with construction activities, you may skip to MCM #6, otherwise complete all questions for BMPs #4 - #6 in this section.

BMP #4: Require the implementation of a combination of structural and/or non-structural BMPs that are appropriate to the local community, that minimize water quality impacts, and that are designed to maintain pre-development runoff conditions.

1. Specify the number of PCSM Plans reviewed during the reporting period for projects disturbing greater than or equal to one acre (including projects less than one acre that are part of a larger common plan of development or sale):
2. Has a tracking system been established and maintained to record qualifying projects and their associated BMPs?
 Yes No

PCSM BMP INVENTORY

Table 1. To complete the information needed for MCM #5, BMP #3, list all existing structural BMPs that discharge stormwater to the permittee's MS4 that were installed to satisfy PCSM requirements for earth disturbance activities under Chapter 102, and provide the requested information (see instructions).

BMP No.	BMP Name	DA (ac)	Entity Responsible for O&M	Latitude	Longitude	Date Installed	O&M Requirements	NPDES Permit No.
1	Artman Home AG Basin 1	7.89	Artman Home	40°09'55"	75°13'18"	2009		
2	Artman Home AG Basin 2	2.89	Artman Home	40°09'59"	75°13'12"	2009		
3	Artman Home UG Basin	1.93	Artman Home	40°09'56"	75°13'17"	2009		
4	Station Square UG Basin	4.60	Station Square	40°08'52"	75°13'14"	2009		PAI010907009
5	Boiler House UG Basin	2.40	Ambler Boiler House	40°09'02"	75°13'24"	2012		
6	Bottom Dollar UG BMP	2.38	Bottom Dollar	40°09'22"	75°13'07"	2013		GP114612329
7	Ambler Crossings		Ambler Crossings Development Partners, LP	° ' "	° ' "	2016		PAI014613008
8				° ' "	° ' "			
9				° ' "	° ' "			
10				° ' "	° ' "			
11				° ' "	° ' "			
12				° ' "	° ' "			
13				° ' "	° ' "			
14				° ' "	° ' "			
15				° ' "	° ' "			

16				o ' "	o ' "			
----	--	--	--	-------	-------	--	--	--

BMP #5: Ensure that controls are installed that shall prevent or minimize water quality impacts. The permittee shall inspect all qualifying development or redevelopment projects during the construction phase to ensure proper installation of the approved structural PCSM BMPs. A tracking system (e.g., database, spreadsheet, or written list) shall be implemented to track the inspections conducted and to track the results of the inspections (e.g., BMPs were, or were not, installed properly).

1. During the reporting period have you inspected all qualifying development and redevelopment projects during the construction phase to ensure proper installation of approved structural BMPs?
 Yes No Not Applicable (no qualifying projects during reporting period)
2. Has a tracking system been established and maintained to record results of inspections?
 Yes No

BMP #6: Develop a written procedure that describes how the permittee shall address all required components of this MCM.

Have you developed a written plan that addresses: 1) minimum requirements for use of structural and/or non-structural BMPs in plans for development and redevelopment; 2) criteria for selecting and standards for sizing stormwater BMPs; and 3) implementation of an inspection program to ensure that BMPs are properly installed? Yes No

MCM #5 Comments:

MCM #6 – POLLUTION PREVENTION / GOOD HOUSEKEEPING

BMP #1: Identify and document all operations that are owned or operated by the permittee and have the potential for generating pollution in stormwater runoff to the MS4. This includes activities conducted by contractors for the permittee.

1. Have you identified all facilities and activities owned and operated by the permittee that have the potential to generate stormwater runoff into the MS4? Yes No
2. When was the inventory last reviewed? Summer 2018
3. When was it last updated? Spring 2016

BMP #2: Develop, implement and maintain a written O&M program for all operations that could contribute to the discharge of pollutants from the MS4, as identified under BMP #1. This program shall address stormwater collection or conveyance systems within the regulated MS4.

1. Have you developed a written O&M program for the operations identified in BMP #1? Yes No
2. Date of last review or update to written O&M program: May, 10, 2016

BMP #3: Develop and implement an employee training program that addresses appropriate topics to further the goal of preventing or reducing the discharge of pollutants from operations to the regulated small MS4. All relevant employees and contractors shall receive training.

1. Have you developed an employee training program? Yes No
2. Date of last review or update to training program: Summer 2018 Date of latest training: Training scheduled for next cycle.

3. Training topics covered:
4. Name(s) of training presenter(s):
5. Names of training attendees:

MCM #6 Comments:

POLLUTANT CONTROL MEASURES (PCMs)

Indicate the status of implementing PCMs in Appendices A, B and/or C by completing the table below. Skip this section if PCMs are not applicable.

Task	Date Completed	Attached	Anticipated Completion Date
Storm Sewershed Map(s)		<input type="checkbox"/>	
Source Inventory		<input type="checkbox"/>	
Investigation of Suspected Sources		<input type="checkbox"/>	
Ordinance/SOP for Controlling Animal Wastes		<input type="checkbox"/>	

PCM Comments:

POLLUTANT REDUCTION PLANS (PRPs) AND TMDL PLANS

1. Complete this section if the development and submission of a PRP and/or TMDL Plan was required as an attachment to the latest NOI or application or was required by the permit, regardless of whether DEP has approved the plan(s).

Type of Plan	Submission Date	DEP Approval Date	Surface Waters Addressed by Plan
<input type="checkbox"/> Chesapeake Bay PRP (Appendix D)			Chesapeake Bay
<input type="checkbox"/> Impaired Waters PRP (Appendix E)			
<input type="checkbox"/> TMDL Plan (Appendix F)			
<input type="checkbox"/> Combined Chesapeake Bay / Impaired Waters PRP			Chesapeake Bay,
<input checked="" type="checkbox"/> Combined PRP / TMDL Plan	9/13/17	Not Yet Approved	Wissahickon Creek

- Joint Plan (if checked, list the name of the MS4 group or names of all entities participating in the joint plan below)
Joint Plan Participants:

2. Identify the pollutants of concern and pollutant load reduction requirements under the permit (see instructions).

Type of Plan	TSS Load Reduction (lbs/yr)	TP Load Reduction (lbs/yr)	TN Load Reduction (lbs/yr)
<input type="checkbox"/> Chesapeake Bay PRP (Appendix D)			
<input type="checkbox"/> Impaired Waters PRP (Appendix E)			
<input type="checkbox"/> TMDL Plan (Appendix F)			
<input type="checkbox"/> Combined Chesapeake Bay / Impaired Waters PRP			
<input checked="" type="checkbox"/> Combined PRP / TMDL Plan	37,202	N/A	N/A

3. Date Final Report Demonstrating Achievement of Pollutant Load Reductions Due:

4. Have any modifications to the plan(s) occurred since DEP approval? Yes No

If Yes to #4, was the updated plan(s) submitted to DEP? Yes No

If Yes to #4, did you comply with the public participation requirements of the applicable appendix? Yes No

If Yes to #4, describe the plan modifications.

5. Summary of progress achieved during reporting period.

PRP and TMDL strategies are still under review by PADEP. Awaiting comments before making revisions or enacting plan.

6. Anticipated activities for next reporting period.

PRP/TMDL Plan Comments:

NEW BMPs FOR PRP/TMDL PLAN IMPLEMENTATION

Table 2. List all new structural BMPs installed and ongoing non-structural BMPs implemented during the reporting period that are being used toward achieving load reductions in the permittee's PRP and/or TMDL Plan (see instructions).

BMP No.	BMP Name	DA (ac)	% Imp.	BMP Extent	Units	Latitude	Longitude	Date Installed or Implemented	Planning Area?	Ch. 102?	Annual Sediment Load Reduction (lbs/yr)
						o ' ' "	o ' ' "		<input type="checkbox"/>	<input type="checkbox"/>	
						o ' ' "	o ' ' "		<input type="checkbox"/>	<input type="checkbox"/>	
						o ' ' "	o ' ' "		<input type="checkbox"/>	<input type="checkbox"/>	
						o ' ' "	o ' ' "		<input type="checkbox"/>	<input type="checkbox"/>	
						o ' ' "	o ' ' "		<input type="checkbox"/>	<input type="checkbox"/>	

BMP INVENTORY FOR PRP/TMDL PLAN IMPLEMENTATION

Table 3. List all existing structural BMPs that have been installed in prior reporting periods and are eligible to use toward achieving load reductions in the permittee's PRP and/or TMDL Plan (see instructions).

BMP No.	BMP Name	DA (ac)	% Imp.	BMP Extent	Units	Latitude	Longitude	Date Installed	Annual Sediment Load Reduction (lbs/yr)	Date of Latest Inspection	Satisfactory?
						o ' ' "	o ' ' "				<input type="checkbox"/>
						o ' ' "	o ' ' "				<input type="checkbox"/>
						o ' ' "	o ' ' "				<input type="checkbox"/>
						o ' ' "	o ' ' "				<input type="checkbox"/>
						o ' ' "	o ' ' "				<input type="checkbox"/>
						o ' ' "	o ' ' "				<input type="checkbox"/>

CERTIFICATION

For PAG-13 Permittees: I have read the latest PAG-13 General Permit issued by DEP and agree and certify that (1) the permittee continues to be eligible for coverage under the PAG-13 General Permit and (2) the permittee will continue to comply with the conditions of that permit, including any modifications thereto. I understand that if I do not agree to the terms and conditions of the PAG-13 General Permit, I will apply for an individual permit within 90 days of publication of the General Permit. I also acknowledge that any facility construction needed to comply with the General Permit requirements shall be designed, built, operated, and maintained in accordance with operative laws and regulations.

For All Permittees: I certify under penalty of law that this report was prepared under my direction or supervision in accordance with a system designed to assure that qualified personnel properly gathered and evaluated the information submitted. Based on my inquiry of the person or persons who manage the system, or those persons directly responsible for gathering the information, the information submitted is, to the best of my knowledge and belief, true, accurate, and complete. I am aware that there are significant penalties for submitting false information, including the possibility of fine and imprisonment for knowing violations. See 18 Pa. C.S. § 4904 (relating to unsworn falsification).

MARY AVERSA

Name of Responsible Official

215-646-1000

Telephone No.

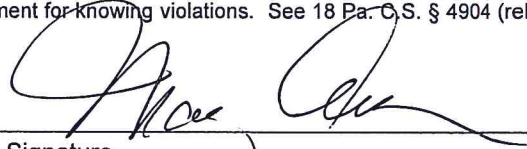

Signature

September 27, 2018

Date

Borough of Ambler
MS4 Progress Report Form
Reporting Period: March 16, 2016 through June 30, 2018
List of Attachments

1. Borough Newsletter excerpts – Spring-Summer 2016, Fall-Winter 2016, Spring-Summer 2017, Fall-Winter 2017, Spring-Summer 2018
2. Published Newspaper Ad – July 30, 2017
3. EAC Events & Wissahickon Valley Watershed Association
4. MCM #3 - IDD&E Dry Weather Discharge Screening Program
5. Borough Public Works O&M Manual & Employee Training Program
6. MS-4 Outfall Map – Last revised May 10, 2016

Attachment 1

Borough Newsletter Excerpts

Borough of AMBLER

HOMETOWN NEWS

www.boroughofambler.com

SPRING/SUMMER 2016



INSIDE THIS ISSUE:

Ambler Main Street Events	2
Environmental Corner	3-4
Summer Jobs.....	4
E-Waste & Special Waste Events	4-5
Wissahickon Valley Public Library	5
Ambler Main Street Event Members	7
Wissahickon Valley Historical Society	8
DA Prescription Drug Disposal.....	8
YMCA Knight Park Summer Camp	8
Park Rules & Regulations.....	9
Police Department News	9-10
Water Department News	10
Tax Collector Notes	11
Montco 2040: A Shared Vision.....	11
Before You Dig – Call 811	11
In Our Community	12
Public Works News	13
Code Enforcement News	13
Trash, Yard Waste & Recycling Schedule	14
Borough of Ambler Directory	17



ENVIRONMENTAL CORNER – Stormwater Management

Jim Dougherty, Engineer, Gilmore & Associates

As we prepare for warmer Spring and Summer days ahead, it is important to keep stormwater runoff in mind. There are a few simple things everyone can do to minimize pollutants carried to our streams and rivers by stormwater runoff.

- Consider using fertilizer with low nitrogen and phosphorus, and make sure to mix your fertilizer into the soil. This will reduce the amount of nutrient runoff that promotes harmful algae blooms in our waterways.
- Keep grass clippings out of the street and storm sewer. These grass clippings can easily cause blockages in stormwater systems, and their decomposition releases excess nutrients into the waterways.
- Consider installing a rain barrel to collect excess stormwater runoff and use it for future car washing or watering.
- It is important that you clean up after pets during walks as well as in your own back yard.
- When performing maintenance on your vehicle, make sure that all oil and antifreeze waste is safely collected and disposed of at approved locations.

With everyone doing their part, our stormwater systems and waterways will look better than ever before! Please refer to the Borough's new Stormwater Management webpage for more information: <http://boroughofambler.com/government/stormwater-management/>.



Environmental Advisory Council

www.amblereac.org

Ambler EAC members are resident volunteers appointed by Borough Council. The EAC works to build awareness of environmental issues in the region, and initiate and sustain projects that improve Ambler's ecological assets. Meetings are held the 3rd Wednesday of each month at 7:00 p.m. at Borough Hall. All residents are invited to attend. For more information, contact the EAC at AmblerEAC@gmail.com.

Preserving Open Space

Edgewoods Preserve - Every municipality identifies and sets aside lands to preserve for Open Space. In densely populated municipalities, such as Ambler, these lands consist mainly of dedicated parks. Open Space is extremely rare in Ambler.

Efforts are underway to acquire and preserve an old-growth woodland located on Edgewood Drive upstream from Hendricks Street. **Edgewoods Preserve** is our name for a parcel of this forested property situated on an environmentally-sensitive bank of the Rose Valley Creek. EAC has initiated a citizen-driven effort to obtain the property for the Borough of Ambler, which will take ownership of the property, restore it and conserve the area as Open Space.

Thankfully, Ambler is taking actions to preserve this lot as a green legacy. Our Borough elected officials have enthusiastically joined this preservation effort. The Wissahickon Valley Watershed Association, many businesses, notably the Ambler Savings Bank, and members of the community have made generous gifts.

To date, \$60,000 has been raised to purchase and preserve the land. Help us to reach our final goal! An additional \$15,000 must be raised by **May 30, 2016**. If you would like to help to preserve this precious woodland, you can make your tax-deductible donation with the Receptionist at Borough Hall or through: <https://www.ioby.org/project/edgewood-preserve>.

Open Space TREE Fest – April 16th - Trees are one of nature's free service providers to humans and non-human animals. The average healthy, mature tree produces roughly 260 pounds of oxygen annually. Each human needs over 20 trees to support their oxygen needs over their lifetime. In one day, one large tree can lift up to 100 gallons of water out of the ground and discharge it into the air. A single tree can intercept 760 gallons of rainwater in its crown, reducing runoff and flooding. Every tree can absorb 10 pounds of air pollutants per year. Trees help prevent flooding and pollution.



The Environmental Advisory Council will hold a public education street fair called: "**Open Space TREE Fest**" on Edgewood Drive on **April 16th** from 11:00am to 2:30pm. This event will feature children's activities, adult presentations, refreshments and music. Our TREE Fest will kick off an initiative called **Plant One Million**, when volunteers will plant 28 new trees on public and residential properties between April 16 and 24. For more information, please contact EAC Associate Susan Curry at suscurry@comcast.net or 215-591-1551.

Wissahickon Creek Clean Up - Saturday, April 30th

Be part of the **46th Annual Creek Clean Up** of the Wissahickon Creek and its many tributaries. Each year the Ambler EAC partners with Wissahickon Valley Watershed Association (WVWA) to help clean up the trail and the creek bed too. Ambler volunteers will focus clean-up efforts on the Rose Valley and Tannery Run tributaries. Trash bags, gloves and other equipment will be provided.

This activity is great for families, scout, school groups and anyone who loves the environment and clean water. Help us clean the creek from top to bottom! To volunteer, please pre-register by E-mail with EAC member Susan Johnsson at Amblereac@gmail.com. Plan to meet at the parking lot of Trax Restaurant at 9 a.m. the morning of the clean-up. And, be sure to wear suitable clothing and shoes.

Following the clean-up join us at the "**Talkin' Trash**" picnic to satisfy appetites and share stories. The picnic will be held at Fort Washington State Park from 11:00 a.m. – 1:00 p.m. at the Flourtown Pavilion on Mill Road.



Borough of

AMBLER

HOMETOWN NEWS

www.boroughofambler.com

FALL/WINTER 2016-17



INSIDE THIS ISSUE:

Ambler Main Street Events	2
Stormwater Management.....	3
Environmental Corner	4
Wissahickon Valley Historical Society	4
American Flag Guidelines	5
Did You Know?	5
Ambler Borough Volunteer Boards	6
Ambler Main Street Event Members	7
Finance Department News.....	8
Public Works News	8
Water Department News	9
Code Enforcement News	10
Construction Corner	10
Trash and Yard Waste News.....	10
Police Department News	11
Wissahickon Fire Company	12
Ambler Choral Society	12
Ambler Symphony Orchestra	13
Wissahickon Valley Public Library	13
Borough of Ambler Directory	17

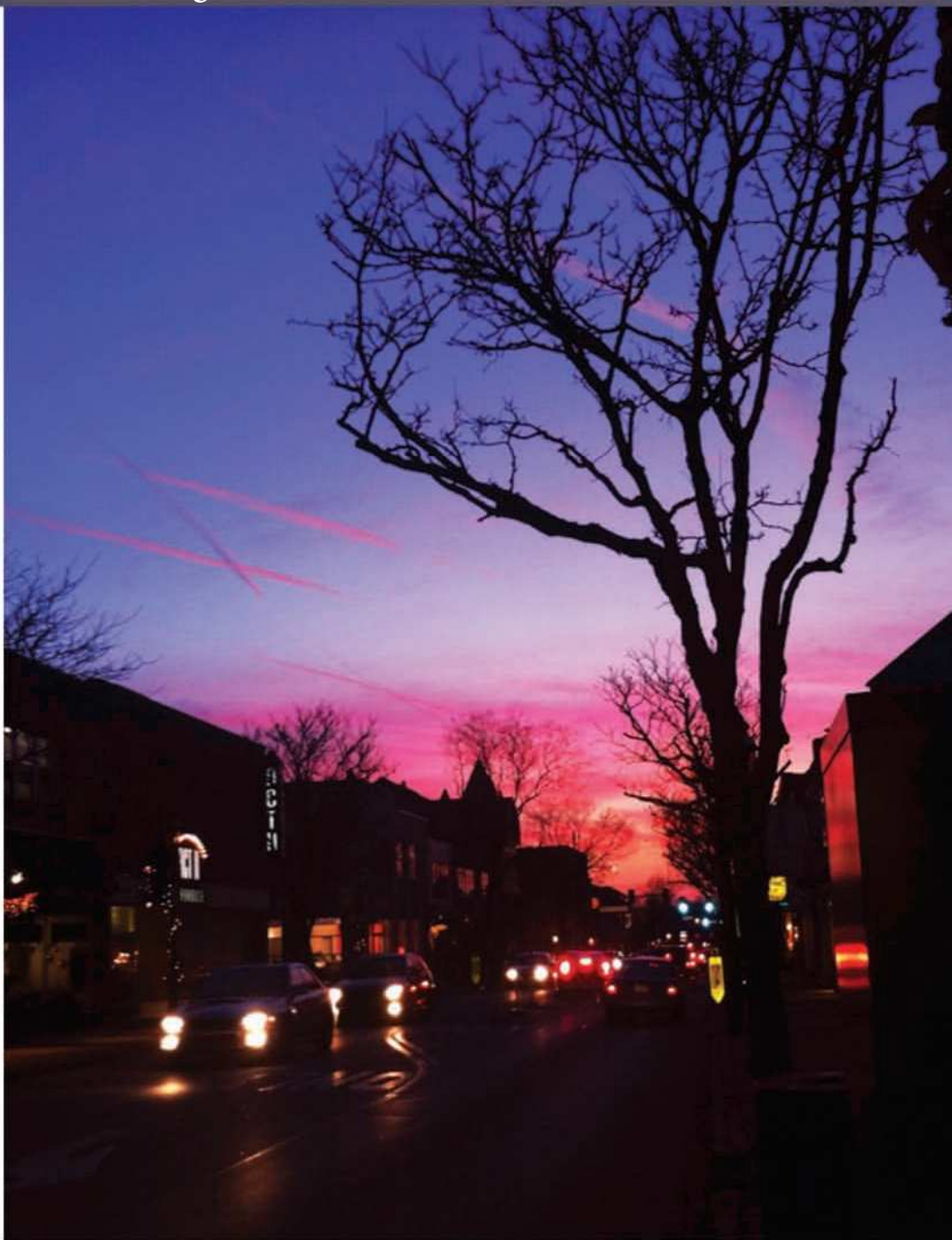



Surface Runoff

Surface runoff is water from rain, snowmelt, or other sources that flows over the land surface and is a major component of the water cycle. Runoff is what occurs when rain is not absorbed by the ground on which it falls and so then flows downhill. As it does so, it will carry topsoil, nutrients, and any other water-soluble material it encounters as it flows downhill. Eventually runoff water will drain into a stream or river. Runoff that occurs on surfaces before reaching a channel is also called overland flow. All of the land whose runoff water flows into a river or stream is known as that stream's watershed.

When runoff flows along the ground, it can pick up soil contaminants such as petroleum, pesticides or fertilizers that become discharge or overland flow. The amount of water that runs off and causes all kinds of problems depends heavily on the amount of rainfall and the type of ground it lands on. Urbanization increases surface runoff, by creating more impervious surfaces such as pavement and buildings which do not allow percolation of water down through the soil to the aquifer. It is instead forced into streams, where erosion and siltation can be major problems, even when flooding is not.

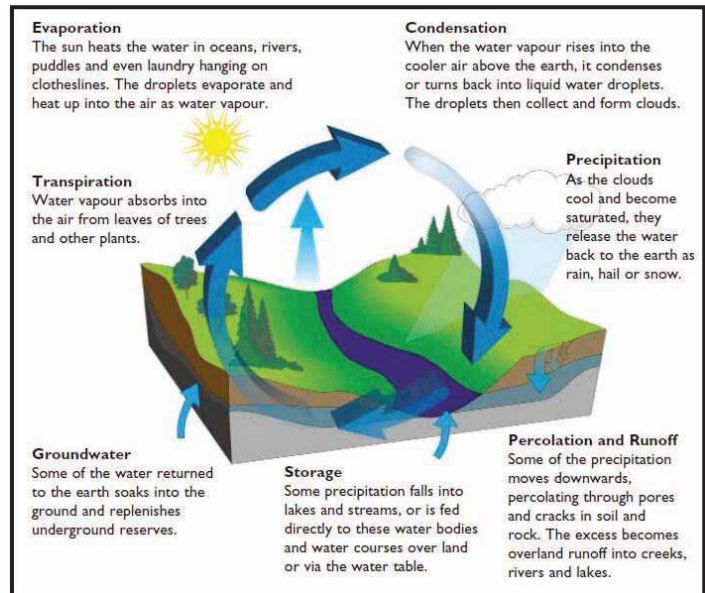

Increased runoff reduces groundwater recharge, thus lowering the water table and making droughts worse.

Meteorological factors affecting runoff:

- Type of precipitation (rain, snow, sleet, etc.)
- Rainfall intensity
- Rainfall amount
- Rainfall duration
- Distribution of rainfall over the drainage basin
- Direction of storm movement
- Precipitation that occurred earlier and resulting soil moisture
- Other meteorological or climatic factors such as temperature, wind, relative humidity and season

Physical characteristics affecting runoff:

- Land use
- Vegetation
- Soil type
- Drainage area
- Basin shape
- Elevation
- Topography, especially the slope of the land
- Drainage network patterns
- Ponds, lakes & reservoirs in the basin, which prevent or delay runoff from continuing downstream

PENNA, GRABOIS & ASSOC., LLC

DOMINIC A. PENNA
ATTORNEY AT LAW

215-643-7866

166 EAST BUTLER AVENUE FAX 215-643-4533
 AMBLER, PA 19002 DPENNA@PENNAGRABOIS.COM

THANK YOU TO THE BUSINESSES!

This publication is made available through the generous advertising sponsorship of the businesses listed throughout our newsletter. We wish to encourage your patronage of these establishments; they play a substantial role in the economic vitality of our community.

Borough of

AMBLER

HOMETOWN NEWS

www.boroughofambler.com

NEW
STREET SWEEPING
SCHEDULE
see page 9

SPRING/SUMMER 2017



INSIDE THIS ISSUE

Environmental Corner.....3, 5-7

- Green Home Stormwater BMPs
- Recycling Information
- Ambler EarthFest 2017
- Wissahickon Creek Clean Up
- Hazardous Waste, Tire Collection & Paper Shredding Events
- Ash Trees Infestations

Ambler Main Street..... 4

Tax Tips From the Tax Collector 7

Departmental News..... 8-9

- Water Department News
- Code Enforcement News
- Public Works News
- Ambler Borough's Newest Park

Public Safety Notes..... 10-11

- Ambler Borough Police Dept
- Spring & Summer Fire Safety
- Community Ambulance Assoc

In Our Community.....11, 13-14

- YMCA Knight Park Summer Day Camp
- Wahl Playground
- Plant Ambler Volunteers
- 2017 Rabies Clinic
- Wissahickon Athletic Club After School Program
- Wissahickon Valley Public Library
- Ambler Symphony

Ambler Borough Directory..... 18

Save the Date!



AMBLER
Arts & Music Festival

June 16 & 17



Photo courtesy of Chris Raines

ENVIRONMENTAL CORNER

Green Home Stormwater BMPs Steve Walsh, P.E., Gilmore & Associates

The Borough of Ambler has a municipal separate storm sewer system (MS4) with multiple outfalls to the Wissahickon Creek and its tributaries. The PA Department of Environmental Protection (PADEP) last issued a general permit for the MS4 in 2013. Wissahickon Creek is designated as a trout stocking stream. In October 2003, the U.S. Environmental Protection Agency (EPA) Region 3 listed Wissahickon Creek as impaired for sediment and both phosphorous and nitrogen based nutrients as it was not meeting its intended use. Subsequently the EPA established a sediment total maximum daily load (TMDL) for the Creek to reduce loads in-stream, thereby allowing the stream to revert back to a more natural state with the idea being that the impairments would then be lifted. Conformance is monitored by the PADEP.



Wissahickon Creek

The Borough's MS4 contributes 68,103 lbs/year of sediment to the Creek. The wasteload allocation is 30,901 lbs/year, resulting in a reduction requirement of 37,202 lbs/year. It is estimated that once best management practice (BMP) measures start to be implemented, it will take the Borough 50 years to comply. The PADEP will require all MS4 Permit holders to commence BMP installation during the next Permit cycle (2018-2023).

In January 2017, Ambler's Environmental Advisory Council (EAC) submitted a Growing Greener Grant application to the PADEP. If awarded, the grant moneys would result in a reduction to the cost each homeowner who wishes to install simple BMPs would incur (hopefully making them free for each homeowner instead of the cost listed below). The BMPs included in the grant and meant for homeowners were 250 rain barrels, 250 down spout planter boxes, and 75 rain gardens intended to reduce stormwater flows in the Creek. The reduction in flow will reduce downstream siltation/sedimentation as lower flows in-stream lead to less turbulent water and less erosion of the stream banks. This soil/sediment being displaced downstream is also laden with nitrogen and phosphorous which can be harmful to the aquatic community and downstream drinking water supplies. It is therefore believed that by reducing sediment load the nutrient loadings will also be reduced.

The following is a list of stormwater collection BMPs that each homeowner can install along with cost and benefit to Wissahickon Creek should all BMPs be installed:

Best Management Practice (BMP)	Average Installation Cost/Unit	Annual Maintenance Cost/Unit	Approximate Impervious Area Served (ft ²)	Sediment Removal (lbx/year)	Phosphorous Removal (lbs/year)	Nitrogen Removal (lbs/year)
55 Gallon Rain Barrel	\$216	\$5*	100	75.8	0.5	1.2
Down Spout Planter Box	\$285-\$400	\$10**	400-900	580	3.62	3.15
Rain Garden	\$750+	\$15	900	174	1.08	0.95

*If properly maintained a rain barrel can be used for 10 years or more without having to replace any parts. Improper winterization could lead to higher maintenance costs as parts will wear sooner.

**Soil replacement is suggested every few years. Cost shown is an average that may not be incurred every year



The Borough of Ambler receives on average approximately 4 feet of precipitation a year. Each of these BMPs is designed to treat the first 1-2 inches of each storm. The Growing Greener Grant application was for the homeowner intended BMPs previously listed, as well as riparian buffer plantings along 20 stream segments in the Borough. If all BMPs are installed and maintained the result would be a reduction in sediment, phosphorous, and nitrogen of 1,038 lbs/year, 5.8 lbs/year, and 5.8 lbs/year, respectively. For more information about these BMPs or how you can help reduce flow to Wissahickon Creek please contact the Borough or visit <http://www.boroughofambler.com/government/stormwater-management/>.

Borough of

AMBLER

HOMETOWN NEWS

www.boroughofambler.com

FALL/WINTER 2017-18



INSIDE THIS ISSUE

Ambler Main Street.....3

Environmental Corner.....4-5

- Stormwater Management
- Recycling News
- 'Trash Talk'
- Battery Solutions

In Our Community.....7-9

- Ambler Parks & Recreation News
- Purchase Discount Tickets Here!
- Ambler Choral Society
- Dog Licensing Procedures
- MONTCO Sign Ups & Notifications
- Ambler Symphony
- MONTCO Parks, Trails & Historic Sites
- Toys For Tots
- American Red Cross Blood Drives
- Wissahickon Valley Public Library

Public Safety Notes.....11-12

- Ambler Borough Police Department
- PA One Call System 8-1-1
- Fall Fire Safety Tips from the Fire Marshall

Departmental News.....13-14

- Public Works Department News
- Code Enforcement News
- Water Department News

Ambler Borough Directory.....18

Cover Photo by Chris Raines

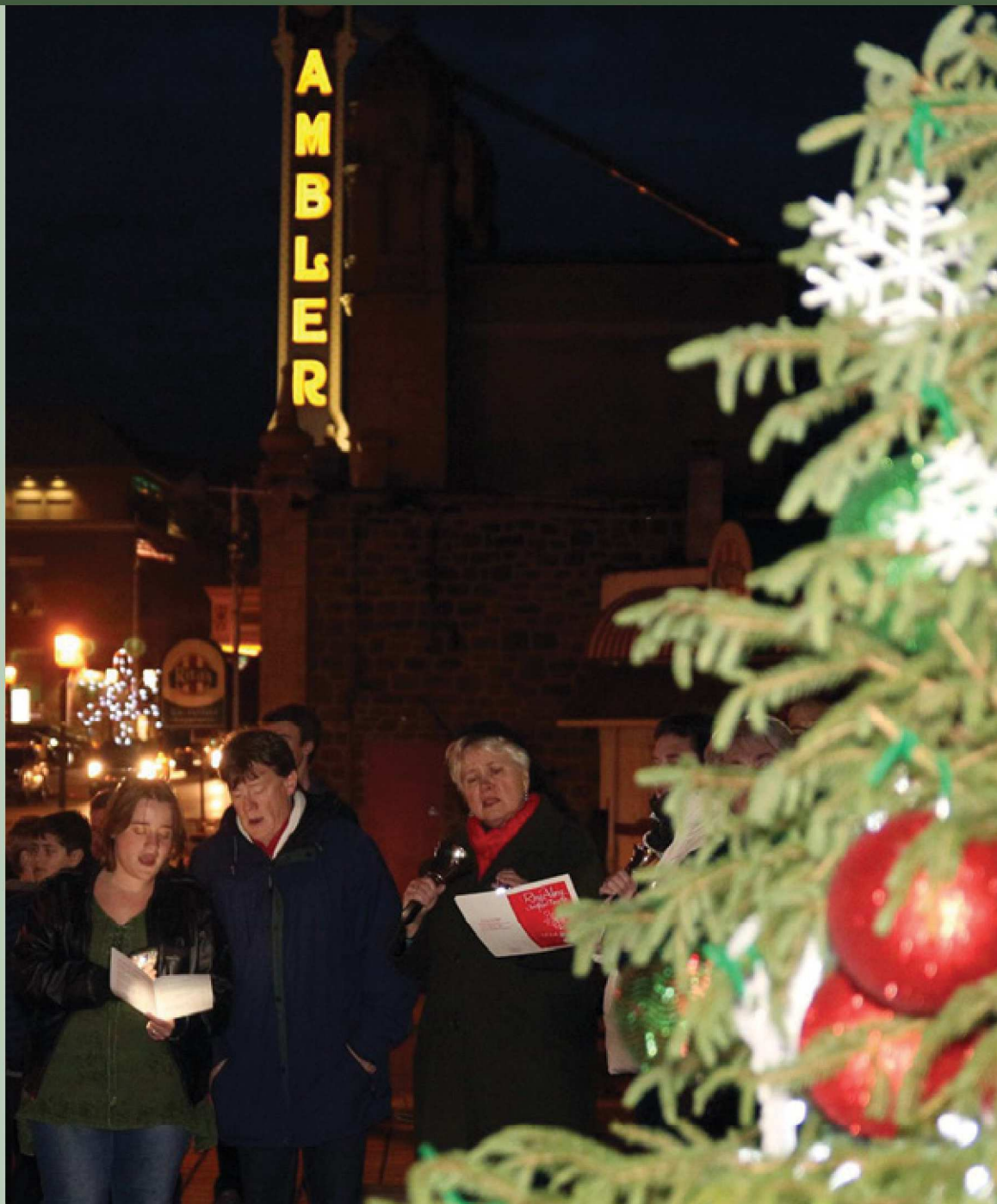



Stormwater Management: Our Fall & Winter Seasons

Jim Dougherty, P.E., Gilmore & Associates

As we prepare for the fall and winter seasons, it is important to be mindful of our outdoor maintenance activities and how they impact the environment, especially those that affect the quality of our waterways. We can limit negative impacts by making a few simple and easy changes.

Here are some suggestions:

1. Use low nitrogen and phosphorus fertilizers in lawn and garden areas, and use these sparingly. This will reduce the amount of nutrients carried away by stormwater.
2. Keep leaves, yard waste and other debris out of the gutters. These get carried away by rain and melting snow, decay in streams and impact water quality and wildlife. Gutter guards in your downspouts are preferred and leaf removal from the street is encouraged to help the Borough.
3. Use salt and deicers only when and where appropriate, and apply the least amount necessary to keep surfaces safe. Deicers are ineffective when greater than 3-inches of snow has accumulated. Store in a dry, covered area to prevent runoff and sweep up excess de-icing materials if a storm does not occur.
4. Clean up after your pet year round during walks, as well as in your own back yard, as animal waste contributes to stormwater contamination.
5. Consider planting native trees and shrubs on your property, they are best suited for our climate, conserve water and require less fertilizer/pesticide applications. Many are available at local garden centers. Autumn is the perfect time for planting; the cool weather gives new plants a chance to establish their root system before the ground freezes.

Recycling News

Plastic Recycling Facts: Enough plastic is produced in the United States each year to shrink wrap Texas. Enough plastic bottles are thrown away in the U.S. each year to circle the Earth four times. For each ton of plastic recycled we save the equivalent of...

- The energy used by 2 people in 1 year.
- The amount of water used by 1 person over two months.
- 2,000 pounds of oil.

Paper Recycling Facts: Recycling one ton of paper would ...

- Save enough energy to power the average American home for 6 months.
- Save 7,000 gallons of water.
- Save 3.3 cubic yards of landfill space.
- Reduce greenhouse gas emissions by one metric ton of carbon equivalent (MTCE).
- Save 17 mature trees.
- Save 2 barrels of oil.
- Save 4,000 kilowatt hours of electricity.

Tips to Reduce, Reuse & Recycle

- Use products made with recycled materials.
- Use energy-efficient light bulbs and rechargeable batteries.
- Shop with cloth bags.
- Reuse plastic bags, cups, containers, etc.
- Repair items instead of throwing them away.
- Compost your food and yard waste.



Food & Beverage Cartons are Recyclable

Recycling for food and beverage cartons is now available to 60% of U.S. households, and cartons are being labeled by manufacturers with the recycling symbol. Most of the material recovery facilities or MRFs where Montgomery County material is processed, recover cartons for recycling. Local participating MRFs include the Borough's hauler J.P. Mascaro. Product containers that are in the carton category include: **food and beverage cartons such as milk, juice, soup, broth, etc.** We want to make sure that residents know that they should put their food and beverage cartons into their mixed recycling bins. Let's recycle more and waste less!

Borough of AMBLER

HOMETOWN NEWS

www.boroughofambler.com

Spring/Summer 2018



© Christine Raines



Cover photos by
Chris Raines



AMBLER
Arts & Music Festival

June 15 & 16

ENVIRONMENTAL CORNER

What is a Rain Garden?

A shallow landscaped depression that captures, cleans, and absorbs stormwater.

Native plants do not require fertilizer, and absorb runoff and pollutants

Native plants attract birds and butterflies

Runoff is collected from hard surfaces and directed into the garden

Depression filled with mixture of sand, topsoil and compost

Existing soil

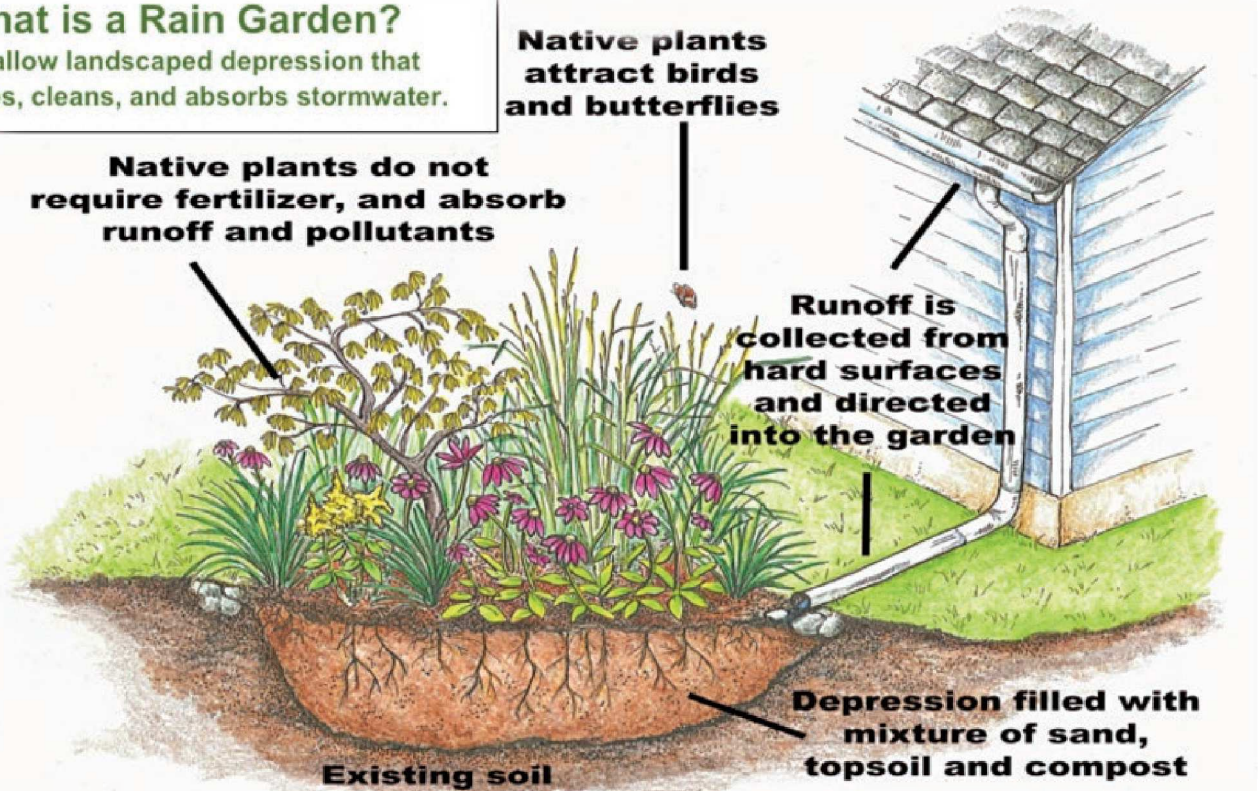

As we prepare for the warm Spring and Summer days ahead, it is important that we be mindful of not only our lawns and gardens, but of the lawns, gardens and waterways to which our stormwater drains. Each year, our environment is under attack by polluted stormwater runoff. We can reduce negative impacts by making a few simple and easy changes to our everyday routines.

Here are some suggestions:

1. Use low nitrogen and phosphorus fertilizers. This will reduce the amount of nutrients carried away by rain water.
2. Mulch grass clippings and remove excess grass clippings from your lawn and paved surfaces after mowing.
3. Consider installing a rain barrel to collect excess stormwater runoff and use it for future car washing or plant watering!
4. Clean up after your pet during walks, as well as in your own back yard. Animal waste contributes to stormwater contamination.
5. When performing maintenance on your vehicle, make sure that all waste oils and fluids are safely collected and disposed of at approved locations, and be sure to address vehicle leaks promptly.

If you're inspired to do more for our environment a Rain Garden is a beautiful addition to your property that is a green, sustainable solution that is low-cost and easy to construct.

For more information about Ambler's Stormwater Program or about rain gardens and other Stormwater Best Management Practices (BMPs) please contact the Borough of Ambler or visit its webpage (<http://www.boroughofambler.com/government/stormwater-management/>). The Ambler Environmental Advisory Council (EAC) also provides valuable information regarding rain gardens and other BMPs (<http://www.amblereac.org/>). [Article contributed by Jim Dougherty, P.E., Gilmore & Associates]

Interesting Facts About Paper Recycling

- Around 1 billion trees worth of paper are thrown away every year in the U.S.
- To produce each week's Sunday newspapers, 500,000 trees must be cut down.
- Every ton of paper recycled saves more than 3.3 cubic yards of landfill space.
- One million tons of recovered paper is enough to fill more than 14,000 railroad cars.
- Recycled paper produces 73% less air pollution than if it was made from raw materials.
- It takes 24 trees to make 1 ton of newspaper.
- An average American uses 465 trees worth of paper during their lifetime.
- Recycling half the world's paper would free 20 million acres of forest land.
- Paper plus cardboard combined make up 73% of the materials in a landfill.



Additional recycling information is available on the Borough website, the County website www.MontcoPARecycles.org, or the Northern Montgomery County Recycling Commission website www.northmontcorecycle.com.

Attachment 2

Published Newspaper Ad

Proof of Publication of Notice
THE AMBLER GAZETTE

State of Pennsylvania,
County of Montgomery ss:

Elizabeth Douglas, Designated Agent of MONTGOMERY NEWSPAPERS LLC, a corporation of the County and State aforesaid, being duly sworn, deposes and says that THE AMBLER GAZETTE is a weekly newspaper published at Ambler, County and State aforesaid, which was established in the year 1879, since which date said newspaper has been regularly issued in said County, and that a copy of the printed notice of publication is attached hereto exactly as the same was printed and published in the regular editions and issues of the said weekly newspaper on the following dates, viz:

LEGAL NOTICE

NOTICE OF PUBLIC COMMENT PERIOD AND PUBLIC MEETING for the NPDES Storm-water Discharges from MS4 Pollutant Reduction Plan for Borough of Ambler (PRP). The PRP outlines the measures the Borough intends to implement to reduce certain pollutants discharged from the Borough's municipal separate storm sewer system (MS4). The PRP is based upon and is intended to supplement the Borough MS4 TMDL Strategy submitted to PADEP in 2015. The PRP includes a summary of the existing loading of the pollutants of concern, a calculation of the minimum reduction required, and a selection of potential Best Management Practices (BMPs) intended to achieve the minimum required reduction. The Borough is soliciting written comments on the PRP. Interested persons may submit written comments during the thirty (30) day period of August 1, 2017 through August 30, 2017. The document may be reviewed during the comment period at Ambler Borough Hall, 131 Rosemary Avenue, Ambler, PA 19002 weekdays between 9AM and 4PM during the comment period. The document is also available for review on the Borough website (<http://boroughofambler.com/>). Written and verbal comments will be accepted at the public meeting scheduled at 7PM on August 15, 2017 at Ambler Borough Hall. Comments must be submitted in writing to the address above (Attn: Borough Manager) or by email to manager@borough.ambler.pa.us and must include originator's name and address. Comments submitted by facsimile will not be accepted.
Gaz-July 30-1a

the 30th day of July, A.D 2017

Affiant further deposes she is duly authorized by Montgomery Newspapers LLC, a corporation publisher of The Ambler Gazette, a weekly newspaper, to verify the foregoing statement under oath and also declares the affiant is not interested in the subject matter of the aforesaid notice or publication, and that all allegations in the foregoing statement as to time, place and character of publication are true.

Agent, Montgomery Newspapers LLC, a Corporation

Sworn to and subscribed by me this 1st day of August, 2017

Notary Public
My Commission Expires: 3/31/2021

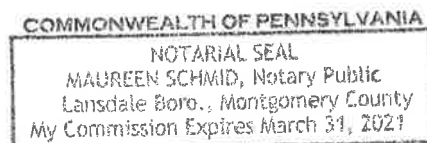

Attachment 3

EAC Events & Wissahickon Valley Watershed Association

100 RAIN GARDENS OF AMBLER

Please join in!

Ambler's 100 Rain Gardens Campaign

The Ambler Environmental Advisory Council (EAC) kicked off our multi-year Rain Garden Campaign in October 2012 with the installation of three residential rain gardens! Volunteers, homeowners and EAC members designed, built and planted rain gardens on several properties in Ambler Borough. Since its inception, 23 rain gardens have been put in place within Ambler Borough. Once the native plants become established, these rain gardens add beauty and function to properties.

We are seeking interested homeowners, to help our community be a solution to the stormwater issues associated with increased development in the Wissahickon Watershed. Join us in meeting our goal of 100 successful Rain Gardens in the Borough of Ambler!

Interested homeowners can benefit from assistance and incentives for the rain garden, including:

- The EAC, Penn State Master Watershed Stewards, and Rain Garden specialist will provide a site evaluation to determine the feasibility of a rain garden on your property;
- The EAC will assist in the layout, plant sharing, and planting. We will also be available as a resource for Rain Garden issues;
- The EAC will provide Rain Garden workshops in the fall and spring throughout the campaign, which landowners will be asked to attend.

What does the homeowner need to do?

First, contact the EAC at amblereac@gmail.com (mailto:amblereac@gmail.com) with an expression of interest. An EAC member will get back to you with additional information.

Once we contact you, you will then need to:

- provide property access to our technical partners to determine soil suitability;
- participate in a Rain Garden Workshop
- read and agree to a Homeowner's Partnership Agreement

The EAC will be holding Rain Garden Workshops in the spring and fall of each year. These workshops will provide homeowners from Ambler Borough and beyond the information needed to calculate the appropriate size and design of a rain garden on their property. EAC representatives will guide you through the process.

Why are rain gardens important?

Stormwater runoff from urban areas increases flooding and carry's pollutants from impervious surfaces such as streets, parking lots and even lawns into our stormdrains which empty into the Rose Valley, Tannery Run or Stewart Farm creeks before emptying into the Wissahickon Creek. Treating this polluted runoff requires costly municipal improvements in stormwater treatment structures. Rain gardens,

however, are less costly and more efficient at managing stormwater runoff from roofs, driveways, and sidewalks associated with residential properties. Almost every property can install a rain garden leading collectively to water quality improvements.

The benefits of a rain garden:

- **increase** the amount of water that filters into the ground and recharges local and regional aquifers;
- **help protect communities** from flooding and related drainage problems;
- **help protect streams** from pollutants carried by urban stormwater runoff, such as lawn fertilizers, pesticides, oil, and other fluids that leak from cars, and pollutants from our roofs and driveways.
- **enhance the beauty** of yards and neighborhoods; and
- **provide valuable habitat** for birds, butterflies, and many beneficial insects.

Contact the EAC and support Ambler's Rain Garden Campaign

AmblerEAC@gmail.com (mailto:AmblerEAC@gmail.com)

Mitch Cashatt [215-920-4965](tel:215-920-4965) (call:2159204965)

The Ambler Rain Garden Campaign supports the Delaware Estuary and the Rain Gardens for the Bays Campaign. For general information on rain gardens, please visit www.raingardensforthebays.org (<http://www.raingardensforthebays.org>)

Events (<http://www.amblereac.org/events/>)

Current Projects (<http://www.amblereac.org/current-projects/>)

Living Green (<http://www.amblereac.org/living-green/>)

Meeting Minutes (<http://www.amblereac.org/category/meeting-minutes/>)

Photos (<http://www.amblereac.org/photos/>)



*Llorix One Lite (<http://themeisle.com/themes/llorix-one/>) powered by WordPress
(<http://wordpress.org/>)*



Saturday, April 21, 2018

Time: 10:00am to 2:00pm

Location: Ambler Borough Hall
131 Rosemary Avenue, Ambler, PA 19002

Schedule and Locations (<http://www.amblereac.org/wp-content/uploads/2018/02/Schedule-and-Locations.pdf>)

(Always Be Recycling will be located at Calvary United Methodist Church, Park and Lindenwold Avenues, Ambler, PA)

Details:

The Ambler Environmental Advisory Council will hold an Earth Fest on Saturday, April 21st, 2018 from 10:00am to 2:00pm at Ambler Borough Hall, located on 131 Rosemary Avenue, in Ambler Borough. Organizations whose focus is on environmental issues will display exhibits, tables and interactive educational displays and speakers will give presentations about environmental issues. Activities for children will be offered.

EDUCATION:

- **10:30-11:15**
 - **Wissahickon Valley Watershed Association** (<http://www.wvwa.org/water/>)
 - **Lindsay Blanton:** A Healthy Wissahickon: We All Have a Part to Play – Lindsay will show [A Healthy Wissahickon](https://vimeo.com/89378322) (<https://vimeo.com/89378322>), answer questions and touch on rain barrels and rain gardens as tools residents can employ.
- **11:30-12:15**
 - **Cedar Run Landscapes** (<http://www.cedarrunlandscapes.com/>)
 - **Alden Zove:** A contractor with the Green City Clean Water – Rain Check Program in Philadelphia, Alden Zove will talk about rain gardens and permeable pavers as tools that can help manage stormwater while creating an attractive living area.

- **12:30-1:15**
 - **PennFuture** (<https://www.pennfuture.org/>)
 - **Jacquelyn Bonomo** (<https://www.pennfuture.org/jacquelyn-bonomo>): Jacqui will talk about the special waters of Pennsylvania and about PennFuture's work in the Delaware, Susquehanna and Ohio watersheds. Find out what you can do to help protect your local water
- **1:30- 2:00**
 - **Infrastructure Solution Services** (<https://www.issdesignbuild.com/>)
 - **Kate Henry**: Kate will talk about the impact of Ambler's stormwater runoff on regional waterways, and how we can do our part by implementing best management practices (BMP's) and the importance of maintaining our green stormwater infrastructure (GSI).

ART:

- Earth Day Themed Art Exhibition and Auction by Connie Liu opens April 20th at Ambler Borough Hall. In this gallery, Connie and several other high school artists from the surrounding area create art both celebrating the beauty of our natural world as well as advocating and highlighting issues dealing with ocean pollution. Some art will be available for sale and all proceeds will go towards installing recycling bins in downtown Ambler.

EXHIBITORS:

- **Always Be Recycling** (<http://www.alwaysberecycling.com/>)
 - We handle recycling carefully and respectfully to give our customers increased confidence that used and end-of-life electronics are managed in an environmentally responsible manner that is in accordance with all local, state and federal regulations. Reuse is the highest form of recycling and we guarantee that no reusable product or material is wasted. Time to drop off those electronics you have been wanting to get rid of. Subject to **restrictions and fees** (<https://drive.google.com/file/d/1Hmfl6nkW1B5exWuJMfLgyGRcbT8HdKsr/view?usp=sharing>) for some items.
- **Back to Earth Composting Crew** (<https://backtoearthcompost.com/>)
 - Did you know that 30-40% of the United States Food supply goes to waste? And nearly half of it is household food that ends up in landfills. Our mission at Back to Earth Compost Crew is to keep that food waste out of landfills and incorporate it back into the soil in our communities.
- **Bartlett Trees** (<https://www.bartlett.com/locations/Ambler-PA.cfm>)
 - Stephen Hilbert from Bartlett Trees will be sharing the role of trees in our community. Bring your tree questions to Stephen. The Arborists in the Eastern Montgomery County office are committed to helping local residents and businesses maintain beautiful, healthy trees and shrubs. Bartlett arborists are experts in diagnosing and treating tree and shrub problems specific to the Eastern Montgomery County area.
- **Lower Gwynedd Environmental Advisory Council** (<https://www.facebook.com/GwyneddGreen-143127989061632/>)
 - Our neighbors at the Lower Gwynedd EAC will support community outreach in Wissahickon Watershed issues.
- **Cedar Run Landscapes** (<http://www.cedarrunlandscapes.com/>)
 - Cedar Run Landscapes is a design-build residential and commercial North Wales landscape designer. With more than 30 years of experience, our landscape design principals embrace the concept of sustainability and the long-lived relationships between the landscape and their users. Member of Philadelphia's Green City Clean Waters – Rain Check program.
- **Evergreen Lane Farm** (<http://www.evergreenlanefarm.net/>)
 - Brian Haentze and Jamie Romani are husband-and-wife partners in Evergreen Lane Farm, a 15-acre USDA-certified organic aquaponics farm in Harleysville, PA. We sell Aquaponic produce, which is grown in our 3000 square foot building, containing a processing room and store. In addition, we sell **Aquaponic growing kits** (<http://www.evergreenlanefarm.net/shop-aquaponic-kits/>) for home owners and small commercial growers.

- **GLDesigns** (<http://gldesigns.net/landscaper.php>)
 - Combining a background in art, *design*, photography, and landscape architecture to create unique, lasting landscapes in Montgomery County, Bucks County and the surrounding area in PA, NJ, NY. Founded in 1979, GLDesigns has designed and installed projects for clients from Hatboro to The Hamptons.
- **Infrastructure Solution Services** (<https://www.issdesignbuild.com/copy-of-funding>)
 - ISS offers a proven model for meeting EPA/DEP greened-acres mandates, incentivizing property owners, reducing costs, and simplifying the design, construction, and maintenance process.
 - Kate Henry will discuss the role small communities can play in clean water and the importance of maintaining our stormwater tools.
- **Montgomery County Planning Commission** (<https://www.montcopa.org/490/Planning-Commission>)
 - Our services to the general public include demographic information, aerial photography, maps, and publications. Our focus is to serve our citizens by planning well-designed communities with revitalized downtowns, housing choices, efficient transportation systems, scenic open spaces, trails, vibrant employment centers, preserved farmland, and community facilities.
 - The role the County Planning Commission plays in evolving projects like the Ambler Pocket Park, and how this fits into the Montco 2040 Vision.
- **Montgomery County Conservation District** (<http://montgomeryconservation.org/about/>)
 - Brian Vadino: Stormwater Pollution Prevention and Water Conservation
 - Our mission is to protect and improve the quality of life of the residents of Montgomery County and surrounding communities by providing, in cooperation with others, timely and efficient service, education, and technical guidance, for the wise use of our soil, water, and related resources.
- **PennFuture** (<https://www.pennfuture.org/>)
 - Pennsylvania's forests and mountains, lakes and streams, parks and trails provide countless opportunities for outdoor recreation and enjoyment. But the very existence of these healthy ecosystems is a testament to hard fought – and won – public and private battles that previous generations of Pennsylvanians waged. These citizen advocates understood the important role that conservation and environmental protection play in maintaining these special places. PennFuture continues this work today.
- **Penn State Extension Master Watershed Steward** (<https://extension.psu.edu/programs/watershed-stewards>)
 - Master Watershed Stewards work with the community to improve the health of our streams and rivers. To become a Master Watershed Steward, you need a keen interest in the environment, a willingness to learn more and most importantly, a strong desire to make a difference in the community. Whether you are a teacher, an accountant, a construction worker, a homemaker, or retired, **you** can become a Master Watershed Steward!
- **Plant Ambler** (<http://boroughofambler.com/community/keeping-ambler-green-clean/>)
 - Plant Ambler is a community-beautification effort staffed entirely by volunteers and supported by donations. Volunteers have been providing displays such as spring pansies, fall mums and winter greens throughout the borough since 1973. The staff experts are always willing to share their knowledge about gardening with “green” newcomers. If you would like to help them make Ambler a more attractive place to live and work by donating your time or money, call **215-219-6553**.
- **Temple Ambler Aquaponics** (<https://ambler.temple.edu/about/aquaponics-ambler>)
 - Aquaponics is the cultivation of plants and aquatic animals in a self-sustaining, symbiotic environment. How it works: Waste from the fish is converted by beneficial bacteria into an organic food source for the plants. The plants absorb the nutrients and naturally filter the water back into the fish tank. Aquaponics has the benefits of both aquaculture and hydroponics, using 90 percent less water than would be used in soil-based farming and producing fresh food in any size system.
- **TreeVitalize** (<http://www.amblereac.org/current-projects/help-make-ambler-a-shade-better/>)

- Scott McCalla, a Tree Tender, will have a bare root tree on hand. Ambler Borough residents can sign-up for a chance to win a free tree in November. At 1:30pm there will be a tree planting demo! Kids are welcome to help!
- **Upper Dublin High School Environmental Science Department**
 - Connie Liu: Marine Debris: Reducing plastic use and plastics that end up in our oceans. A Bow Seat Ocean Advocacy Program
 - Sabrina Pulli, Jacqueline Gorman, and Lanie Silverman: Upcycled jewelry, proceeds benefit [LifeStraw](http://www.lifestraw.com/our-story/) (<http://www.lifestraw.com/our-story/>), a company dedicated to making contaminated water safe to drink. to LifeStraw, to help people in third world countries have safe drinking water.
 - Natalie Swift and Hayley Webb: Environmental issue in Costa Rica and ways they try to resolve these issues.
 - Emma Lennon: selling stickers to promote environmental awareness. All the money raised will be donated to the charity called “Charity : Water.”
- **Weavers Way** (<http://weaversway.coop/event/earth-day-workshop-how-shop-bulk-save-green>)
 - Partners in Growing Ambler Greener. Weavers Way will be incorporating [Terracycling](https://www.terracycle.com/en-US/) (<https://www.terracycle.com/en-US/>) at their Ambler Store on Saturday April 21. Also check out their informative table on bulk shopping and then attend their [Bulk Shopping Workshop](http://weaversway.coop/event/earth-day-workshop-how-shop-bulk-save-green) (<http://weaversway.coop/event/earth-day-workshop-how-shop-bulk-save-green>) to learn how to shop bulk and save green!
- **Wissahickon High School Senior Project**
 - Rachel Bowman: Creating Momentum for Improved Recycling
- **Wissahickon Valley Public Library** (<http://www.wvpl.org/about-us/services>)
 - Do you know all the services your local library provides for the community? Click on the link to find out, or stop by their table at the Ambler EarthFest.

CHILDREN'S ACTIVITIES:

- **Tinkergarten** (<https://www.tinkergarten.com/leaders/nicole.skinner>)
 - 10-1:30 Nicole is a leader when it comes to outdoor children activities. Get a glimpse of the Tinkergarten Program at EarthFest, high-quality early childhood learning in the healthiest classroom of all—the outdoors.
- **Wissahickon Valley Public Library** (<http://www.wvpl.org/>)
 - 12:30 What young child can resist Miss Michelle's sing-a-long
 - 1:00 Nature story and crafts with Erin
- **Robbins Park Environmental Education Center** (<http://robbinspark.wikispaces.com/>)
 - Robbins Park brings relevant educational programs to the community to encourage stewardship of our natural resources.
- **Weavers Way**
 - 11am – 1pm, Come by **Weavers Way Co-op** to make your own reusable shopping bag! In this workshop you will learn how to quickly convert a clean t-shirt into a reusable shopping bag without sewing! This kid-friendly activity requires some cutting and some hand-tying – volunteers will be on-hand to help. Bring in a shirt (preferably size Medium or larger) if you can; some donated t-shirts will be available.

FOOD:

- **Sweet Briar** (<http://sweetbriarcafe.net/>)
 - Sweet Briar Cafe is Ambler's family friendly place to get great home cooked food anytime of day. And, who remembers walking to this neighborhood venue for ice cream in the summertime?

MUSIC:

- **Steve Hutchman**
 - Ambler’s own “humanity in music” artist.
- **Life in Progress**
 - Life in Progress creates uplifting lyrical harmonies with acoustic guitar and ukulele. Bailey and Mike Hobbs perform original music, inviting the community to gather and create.

AMBLER MAIN STREET

- **Antique Garden Cottage** (<http://www.antiquegardencottage.com/default.html>)
 - Laureen, the new owner of Antique Garden Cottage on Main Street, will be handing out seed packets with every purchase along with a coupon. Don’t miss out on some re-purposed older treasures.
- Xtra 101
- Jackets and Things
- Roost Home
- Wild Lillies
- Main Street Vintage.
- Denny Electric

Shoppers who bring their Shop Small bag or any reusable bag of their own can save \$1 on their purchase (check for store participation). There will be Earth Day sidewalk Sale (weather permitting), specials on sustainable merchandise, and a special Earth Day gift with your purchase. Visit www.amblermainstreet.org for details.

PARKING:

- Ambler Train Station [Directions](#) (<https://www.google.com/maps/dir//septa+parking+lot+ambler/@40.1535361,-75.2202553,17z/data=!4m5!4m4!1m0!1m2!1m1!1s0x8>)
- Ambler is a walk-able community. Please consider walking if you live in Ambler.
- Parking at the Ambler Borough Municipal building will be closed except for handicap accessible spaces.

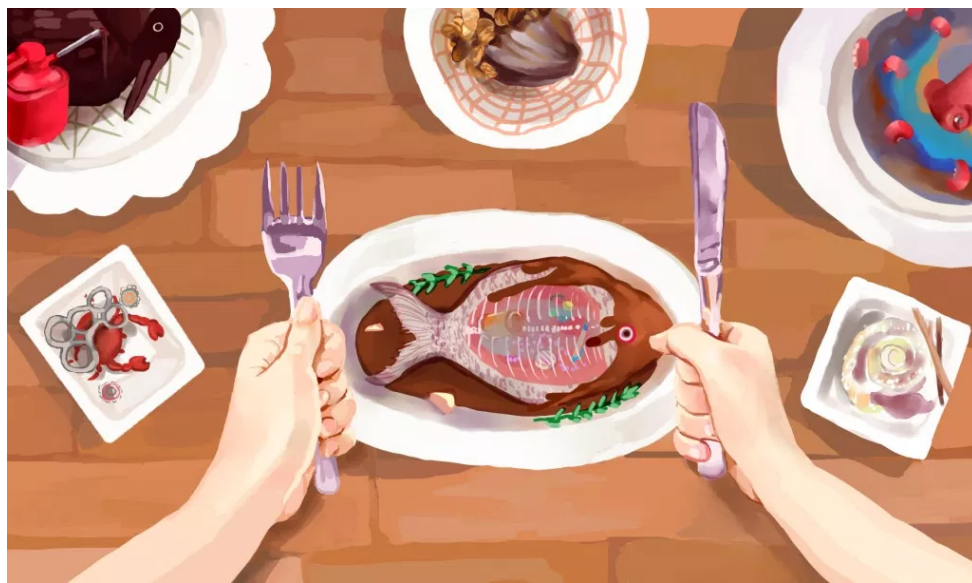

What Goes Around Comes Around

Share this:

 (<http://www.amblereac.org/earth-fest-2018/?share=twitter&nb=1>)  (<http://www.amblereac.org/earth-fest-2018/?share=facebook&nb=1>)

 (<http://www.amblereac.org/earth-fest-2018/?share=google-plus-1&nb=1>)

Related

Ambler Borough Earth Fest 2017

(<http://www.amblereac.org/earth-fest-2017/>)

March 12, 2017

In "Events"

February 18, 2015-02 Meeting Minutes

(<http://www.amblereac.org/eac-meeting-february-18-2015/>)

April 4, 2015

In "Events"

May 29, 2018 Ambler EAC Agenda

(<http://www.amblereac.org/may-29-2018-ambler-eac-agenda/>)

July 16, 2018

In "Agendas"

posted in **EVENTS** ([HTTP://WWW.AMBLEREAC.ORG/CATEGORY/EVENTS/](http://www.amblereac.org/category/events/))

LINDSEY MORRISON-DAKU ([HTTP://WWW.AMBLEREAC.ORG/AUTHOR/LINDSEYMDK/](http://www.amblereac.org/author/lindseymdk/))

« **DECEMBER 20TH 2017 MEETING MINUTES**
([HTTP://WWW.AMBLEREAC.ORG/DECEMBER-20TH-MEETING-MINUTES/](http://www.amblereac.org/december-20th-meeting-minutes/))

AUGUST 16, 2017 AMBLER EAC AGENDA »

Events (<http://www.amblereac.org/events/>) Current Projects (<http://www.amblereac.org/current-projects/>)

Living Green (<http://www.amblereac.org/living-green/>) Meeting Minutes(<http://www.amblereac.org/category/meeting-minutes/>)

Photos (<http://www.amblereac.org/photos/>)

 (<https://www.instagram.com/amblereac/>)

Llorix One Lite (<http://themeisle.com/themes/llorix-one/>) powered by WordPress (<http://wordpress.org/>)

BATTERY RECYCLING PROGRAM



The Borough's Safe Battery Disposal Program

Ambler Borough, working with the Environmental Advisory Council, has set up an environmentally efficient battery recycling drop-off site in the Ambler Borough Hall Lobby for residents to safely dispose of batteries. Batteries contain many chemicals that are unsafe for the environment and they are currently being thrown into the trash.

Battery Solutions provides a simple method compliant with EPA and US DOT standards for residents to recycle batteries. This is not just a disposal program. Battery Solutions is Responsible Recycling (R2:2013) and Recycling Industry Operating Standards (RIOS™) certified. Battery Solutions actually

RECYCLES the batteries in the most environmentally and economically efficient way. This program allows us to reuse our natural resources efficiently and decreases the harmful environmental effects of batteries. It reduces the need for mining and processing of virgin materials. Battery Solutions provides a Confirmation of Reclamation certificate.

Batteries and handheld electronics may be dropped off in the Ambler Borough Hall Office during regular business hours to be placed in the iRecycle Container. The container holds 55 pounds of batteries. The Borough will maintain the drop-off container and send it off to Battery Solutions when full.

PLEASE TAPE THE CONTACT ON EACH END OF YOUR BATTERIES, BEFORE PLACING THEM INTO THE DROP BOX!

Materials Accepted at the Ambler Borough Hall Drop-off Location:

- Alkaline
- Zinc Carbon
- Nickel Cadmium (NiCd)
- Nickel Metal Hydride (NiMH)
- Lithium-ion
- Lithium Primary
- Mercury Batteries
- Silver Oxide
- Button Cells
- Small Electronics (cell phones, iPods, tablets, power tools, etc.)

ALL ITEMS MUST FIT EASILY INTO THE RECYCLING CONTAINER!

How recycling is accomplished:

Alkaline – 100% recycled by using an alternative to High Temperature Metal Recovery (HTMR) most recyclers use. Instead, a non-thermal mechanical decomposition process is used, yielding a higher recycling efficiency rate (RER). This is better for the environment, producing virtually no emissions. It breaks an alkaline battery into three end products: zinc and manganese concentrate, steel and paper, plastic and brass fractions for use in other applications.

Nickel Metal Hydride (NiMH) – Using a proprietary heat treatment, the highest quality nickel feedstock is extracted from these batteries. This nickel is desirable to the steel and alloy market and can be used in making stainless steel products.

Events (<http://www.amblereac.org/events/>)

Current Projects (<http://www.amblereac.org/current-projects/>)

Living Green (<http://www.amblereac.org/living-green/>)

Meeting Minutes (<http://www.amblereac.org/category/meeting-minutes/>)

Photos (<http://www.amblereac.org/photos/>)



(<https://www.instagram.com/amblereac/>)

Llorix One Lite (<http://themeisle.com/themes/llorix-one/>) powered by *WordPress*
(<http://wordpress.org/>)

GROWING AMBLER GREENER

Growing Greener (<https://pagrowinggreener.org/about/mission/>) remains the largest single investment of state funds in Pennsylvania's history to address Pennsylvania's critical environmental concerns of the 21st century. The three priorities of this program include: Conserving Land and Water Resources, Restoring Damaged Waterways and Land, and Creating Prosperous and Sustainable Communities.

Conserving Land and Water Resources

- **Stream Reach Assessment Tool**
(<https://ansdu.maps.arcgis.com/apps/MapSeries/index.html?appid=93878a625c6f4afdb65272d5ca517265>)

Restoring Damaged Waterways and Land

Ambler is a small, densely developed area with limited open space to manage the stormwater that washes off our impervious surfaces. Three creeks run through our Borough: Rose Valley, Tannery Run and Stuart Farm Creeks. Because Ambler has Storm drains we, along with other municipalities with storm drains, must comply with the stormwater requirement of the Federal Clean Water Act to keep our waterways clean. Pennsylvania's Stormwater Management Act (better known as Act 167), MS4 Program, Chapter 102 (Erosion and Sediment Control Requirements), and NPDES Permit Program for Stormwater Discharges Associated with Construction Activities are amongst the Commonwealth's methods for meeting the runoff-related requirements of the Clean Water Act. Currently,

in the Wissahickon Watershed, there are Total Maximum Daily Loads (a way to measure pollutants) for: sedimentation, phosphorous and nitrogen. For a community such as Ambler, it becomes essential to make a difference at a local level. Homeowners can create action by educating themselves and looking for opportunities to make a difference. Employing simple tools can help homeowners with water issues, and our community in working towards cleaner water in the Wissahickon Watershed. **Contact the EAC** (<http://www.amblereac.org/contact-us/>) for a free assessment of your property.

- **Raingardens** (<http://www.raingardennetwork.com/blog/what-is-a-rain-garden/>)
- **Rain Barrels** (<http://epochrainbarrels.com/top-10-benefits-of-rain-barrels/>)
- **Downspout Planters**
(http://www.phillywatersheds.org/whats_in_it_for_you/residents/downspout-planters)
- **Riparian Buffers**
(<https://www.bae.ncsu.edu/programs/extension/wqg/sri/riparian5.pdf>)
- **Steep Slope Terraces**
(<https://environment.arlingtonva.us/2016/06/11745/>)

Creating Prosperous and Sustainable Communities

GROW AMBLER GREENER

(<https://drive.google.com/file/d/0B8ajMh2RMzFMU0ZsT2FmaFhsOFU/view?usp=sharing>)

Events (<http://www.amblereac.org/events/>)

Current Projects (<http://www.amblereac.org/current-projects/>)

Living Green (<http://www.amblereac.org/living-green/>)

Meeting Minutes (<http://www.amblereac.org/category/meeting-minutes/>)

Photos (<http://www.amblereac.org/photos/>)

 (<https://www.instagram.com/amblereac/>)

*Llorix One Lite (<http://themeisle.com/themes/llorix-one/>) powered by WordPress
(<http://wordpress.org/>)*

HELP MAKE AMBLER A SHADE BETTER

Ambler residents are eligible to request a shade tree for your yard this fall.

3 Steps to a fall 2018 tree:

1. Choose a tree by viewing the links below
2. Download and complete the 'Make Ambler A Shade Better Request Form'
3. Return the form with a check by **September 12, 2018**

First tree \$55. Additional trees \$80 each

Step 1: Choose a tree (or two or three):

Small (under 30')

- *Amelanchier x laevis* 'Cumulus' (Cumulus Serviceberry) ** [view](http://plants.oaklandnursery.com/12130001/Plant/611/Cumulus_Serviceberry)
(http://plants.oaklandnursery.com/12130001/Plant/611/Cumulus_Serviceberry)
- *Cornus mas* 'Golden Glory' (Golden Glory Corneliancherry Dogwood) [view](http://www.missouribotanicalgarden.org/PlantFinder/PlantFinderDetails.aspx?kempercode=j920)
(<http://www.missouribotanicalgarden.org/PlantFinder/PlantFinderDetails.aspx?kempercode=j920>)
- *Malus* 'Harvest Gold' (Harvest Gold Crabapple) [view](https://edis.ifas.ufl.edu/st393)
(<https://edis.ifas.ufl.edu/st393>)
- *Prunus sargentii* (Sargent Cherry) [view](http://www.missouribotanicalgarden.org/PlantFinder/PlantFinderDetails.aspx)
(<http://www.missouribotanicalgarden.org/PlantFinder/PlantFinderDetails.aspx>)

kempercode=a913)

Medium (30 to 50')

- *Acer x Freemanii* 'Autumn Blaze' (Autumn Blaze Maple) ** [view](http://www.missouribotanicalgarden.org/PlantFinder/PlantFinderDetails.aspx?kempercode=c789)
(<http://www.missouribotanicalgarden.org/PlantFinder/PlantFinderDetails.aspx?kempercode=c789>)
- *Cercidiphyllum japonicum* (Katsura Tree) [view](http://www.missouribotanicalgarden.org/PlantFinder/PlantFinderDetails.aspx?kempercode=j710)
(<http://www.missouribotanicalgarden.org/PlantFinder/PlantFinderDetails.aspx?kempercode=j710>)
- *Corylus colurna* (Turkish Filbert) [view](http://www.missouribotanicalgarden.org/PlantFinder/PlantFinderDetails.aspx?taxonid=277856)
(<http://www.missouribotanicalgarden.org/PlantFinder/PlantFinderDetails.aspx?taxonid=277856>)
- *Gleditsia t.i.* 'Streetkeeper' (Streetkeeper Honeylocust) ** [view](http://www.missouribotanicalgarden.org/PlantFinder/PlantFinderDetails.aspx?kempercode=a871)
(<http://www.missouribotanicalgarden.org/PlantFinder/PlantFinderDetails.aspx?kempercode=a871>)
- *Tilia cordata* 'Greenspire' (Greenspire Littleleaf Linden) [view](http://www.missouribotanicalgarden.org/PlantFinder/PlantFinderDetails.aspx?kempercode=a918)
(<http://www.missouribotanicalgarden.org/PlantFinder/PlantFinderDetails.aspx?kempercode=a918>)

Large (over 50')

- *Acer saccharum* (Sugar Maple) ** [view](http://www.missouribotanicalgarden.org/PlantFinder/PlantFinderDetails.aspx?kempercode=h240)
(<http://www.missouribotanicalgarden.org/PlantFinder/PlantFinderDetails.aspx?kempercode=h240>)
- *Celtis occidentalis* (Hackberry)** [view](http://www.missouribotanicalgarden.org/PlantFinder/PlantFinderDetails.aspx?kempercode=a858)
(<http://www.missouribotanicalgarden.org/PlantFinder/PlantFinderDetails.aspx?kempercode=a858>)
- *Liriodendron tulipifera* (Tuliptree) ** [view](http://www.missouribotanicalgarden.org/PlantFinder/PlantFinderDetails.aspx?kempercode=a878)
(<http://www.missouribotanicalgarden.org/PlantFinder/PlantFinderDetails.aspx?kempercode=a878>)
- *Quercus bicolor* (Swamp White Oak) ** [view](http://www.missouribotanicalgarden.org/PlantFinder/PlantFinderDetails.aspx?kempercode=q330)
(<http://www.missouribotanicalgarden.org/PlantFinder/PlantFinderDetails.aspx?kempercode=q330>)
- *Tilia americana* 'Redmondi' (Redmond American Linden) ** [view](http://www.missouribotanicalgarden.org/PlantFinder/PlantFinderDetails.aspx?kempercode=c156)
(<http://www.missouribotanicalgarden.org/PlantFinder/PlantFinderDetails.aspx?kempercode=c156>)

- *Ulmus x 'Accolade'* (Accolade Smoothleaf Elm) [view](http://www.chicagolandgrows.org/trees/accoladeelm.php/)
(<http://www.chicagolandgrows.org/trees/accoladeelm.php/>)

*** Native species or cultivars of native species*

2018 Additional Information:

- Only Ambler Borough residents are eligible
- Trees must be planted within 10 feet of the sidewalk, street, driveway or parking lot.
- Planting street trees on your property helps make Ambler a walkable community
- \$55 for your first tree, \$80 for any additional trees
- Drop-off at or mail form & check at Borough Hall
- You will need to dig a hole for the tree or request help from the EAC
- Call 811-dig 2 weeks prior to planting
- You will need to water your tree 10-15 gallons in the spring and summer when there is no rain. You'll need to do this for 2 years until the tree is established

Step 2:

Read and complete the form to order a tree

Make Ambler A Shade Better Request Form (<http://www.amblereac.org/wp-content/uploads/2018/08/TreeVitalizeFlyer.docx>)

Step 3:

- Make your check or money order out to "Ambler Borough". Include in the Memo section "Shade Tree"
- Return your check or money order, with your form, to Ambler Borough Hall at 131 Rosemary Ave, Ambler, PA 19002

Trees will arrive November 15, 2018

Events (<http://www.amblereac.org/events/>)

Current Projects (<http://www.amblereac.org/current-projects/>)

Living Green (<http://www.amblereac.org/living-green/>)

Meeting Minutes (<http://www.amblereac.org/category/meeting-minutes/>)

Photos (<http://www.amblereac.org/photos/>)



(<https://www.instagram.com/amblereac/>)

Llorix One Lite (<http://themeisle.com/themes/llorix-one/>) powered by *WordPress*
(<http://wordpress.org/>)



Search WVWA

- What is a Watershed?
- Creek Clean Up
- Creek Watch Program »
- Wissahickon Clean Water Partnership
- Monitoring & Assessment
- Philly Upstream Cluster
- Protect Our Creek
- Links
- Water Quality FAQs

Home » Water » Wissahickon Clean Water Partnership



become a member
Join Us Today »

sign-up & stay informed
Our Email List »

assist us in our efforts
Volunteer »



Wissahickon Clean Water Partnership

What is the Wissahickon Clean Water Partnership?

The municipalities of the Wissahickon Creek Watershed have joined together to form a coalition of towns and sewer authorities working with the Pennsylvania Department of Environmental Protection (PADEP) and the US Environmental Protection Agency (USEPA) to address our impaired stream health. This coalition, called the Wissahickon Clean Water Partnership, will be working on a plan over the next two years to collaboratively "Own the Solution" for a cleaner Wissahickon Creek.

This voluntary partnership will evaluate the causes of impaired waters and produce a watershed-wide plan to make significant improvements to stream health over the coming years. By working together on a coordinated solution, the Wissahickon Clean Water Partnership aims to ensure that local interests are emphasized, that no municipality is alone in combating pollution, and to help municipalities, sewer authorities and taxpayers keep costs down in the long run.

The ultimate goal of the Wissahickon Clean Water Partnership is to synthesize a holistic watershed plan, called the Water Quality Improvement Plan, that meets the EPA's criteria for impaired creeks, and to implement that plan to protect and improve the Wissahickon Creek for all to enjoy.

Listen to Pennsylvania Legacies 2-part podcast on the state of the Wissahickon:

PEC Podcast - Part 1
Pennsylvania Legacies #28: The Real Wissahickon
Posted March 3, 2017 | By: Josh Raulerson

Follow the conversation online:

[facebook.com/WVWA19002](https://www.facebook.com/WVWA19002)

[@WVWA19002](https://twitter.com/WVWA19002)

[@wissahickonwatershed](https://www.instagram.com/wissahickonwatershed)

WCWP Hashtag:
#CleanWissahickon

Click the image below to view the Community Values graphic

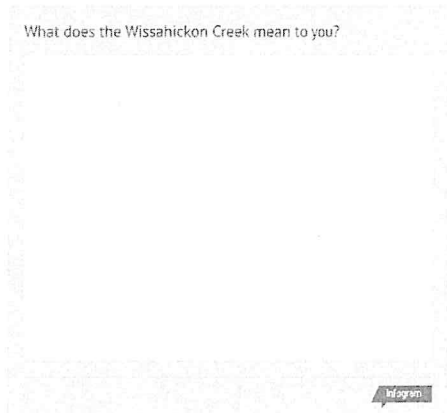

Click the image below to view the WCWP flyer:



PEC Podcast - Part 2
 Pennsylvania Legacies #60: The Right Questions
 Posted November 3, 2017 | By: Josh Raulerson



PEC Podcast - Part 3
 Pennsylvania Legacies #64: A Tale of Two Townships
 Posted January 13, 2018

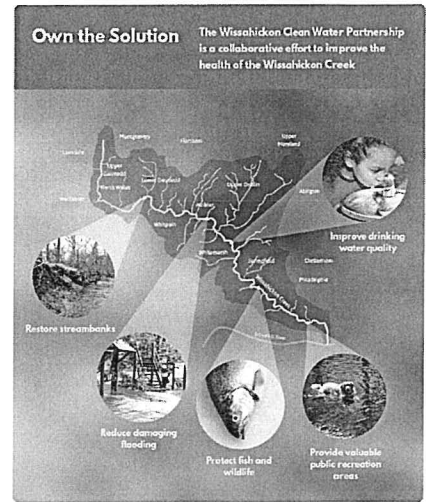

Click the image below for your municipal representatives' contact information.



Watch the full video [here](#)

Who is participating in the Wissahickon Clean Water Partnership?

Municipalities

The following municipalities signed an ordinance in Summer 2016 to participate in the Wissahickon Clean Water Partnership:

- | | |
|-------------------------------|-------------------------------|
| Abington | North Wales |
| Ambler | Philadelphia |
| Cheltenham | Springfield |
| Lansdale | Upper Dublin |
| Lower Gwynedd | Upper Gwynedd |

[Montgomery](#)[Whitemarsh](#)[Whitpain](#)**Wastewater Treatment Plants**

All four wastewater treatment plants in the watershed are also participating:

[Abington Wastewater Treatment Plant](#)[Bucks County Water & Sewer Authority](#)[Ambler Wastewater Treatment Plant](#)[Upper Gwynedd Wastewater Treatment Plant](#)

Each participating municipality and wastewater treatment plant (WWTP) selected two representatives to act on the Management Committee. [Click here for a list of representatives for each municipality.](#)

Water Quality Advisory Team (WQAT)

WQAT is a team of environmental non-profits providing technical assistance in drafting the Water Quality Improvement Plan. The organizations are listed below, with a brief description of their contribution to the Partnership:

Pennsylvania Environmental Council (PEC) will lead the Water Quality Advisory Team, and oversee internal technical team coordination and external communication activities. PEC is also documenting the process as it unfolds, and is interviewing stakeholders of the Partnership on their podcast, Pennsylvania Legacies.



Patrick Starr, Executive Vice President, directs PEC's strategic programs state-wide in: Trails & Recreation; Watersheds; and Energy & Climate, and leads PEC's southeast regional office, located in Center City, Philadelphia.

Temple University Center for Sustainable Communities (CSC) will conduct field monitoring, watershed modeling, and identify and prioritize key strategies to improve water quality in the Wissahickon Creek. Temple CSC will be the lead in drafting the Water Quality Improvement Plan to meet water quality standards.



Dr. Laura Toran, Professor, Department of Earth & Environmental Science, is the principal investigator for this initiative, and has published works in the areas of urban hydrology, nutrients in stormwater, geophysical characterization of streams, and fracture flow modeling. She is a fellow of the Geological Society of America, served on several editorial boards and is a registered professional geologist.

Environmental Finance Center of University of Maryland (EFC) has supported local governments and watershed organizations in the development and implementation of innovative, cost efficient, and feasible financing strategies for over 20 years. EFC will seek to strengthen the capacity of local decision-makers to analyze environmental problems, and develop innovative and effective methods of financing environmental efforts.



Jennifer Cotting, Research Associate, oversees the EFC's green infrastructure programming, which spans both urban stormwater management as well as large landscape conservation. Cotting works with local governments, stakeholders, and project partners, coordinating technical assistance, program analysis, public education and outreach, and provides training and workshop development and management.

Wissahickon Valley Watershed Association (WVWA) will provide outreach to all stakeholders of the Partnership, and will aim to educate the citizens and municipalities of the watershed about this initiative and what it means for the Wissahickon Creek. WVWA is an organization with 60 years of close ties to the community, and will be ambassador to the public regarding this important partnership.



Gail Farmer, Executive Director, leads WVWA staff in the strategic advancement of their mission to protect the quality and beauty of the Wissahickon Creek. Gail has worked at environmental nonprofits for 17 years, with expertise in wildlife ecology, environmental education and nonprofit leadership.

The Montgomery County Planning Commission is also assisting in oversight and moderation of the Wissahickon Clean Water Partnership meetings.

How can I get involved in this effort?

Updates

September 2017

Wissahickon Clean Water Partnership
Assembles "Dream Team" to Review Scientific Recommendations

(Ambler, PA) – September 29, 2017. A group of 13 Montgomery County municipalities and 4 wastewater treatment plants in the Wissahickon Watershed have voted on the selection of a Technical Review Committee to support the ongoing work of the Wissahickon Clean Water Partnership. This voluntary, multi-municipal partnership is exploring alternative approaches to the standard Total Maximum Daily Load regulations imposed by the EPA on water bodies that have been listed as "impaired". Ultimately, the work of this group will result in a shared Water Quality Improvement Plan for the Wissahickon Creek that will guide municipal actions and investments in stormwater infrastructure and wastewater treatment plant upgrades in the coming years. >>> [READ FULL PRESS RELEASE](#)

December 2016

The Management Committee elected their leadership team. The following positions have been filled:

- Paul Leonard** (Upper Dublin Township Manager): Co-Chair
- Mark Grey** (Lower Gwynedd Board of Supervisors): Co-Chair
- George Wrigley** (Abington Director of Wastewater Utilities): Treasurer
- Chris Kunkle** (Lansdale Building Inspector): Secretary

Sub-committees have also been created for the following functions:

- Data Review Subcommittee
- Legal Services and Technical Services RFP Subcommittee

Attachment 4

MCM #3 - IDD&E Dry Weather Discharge Screening Program

Attachment 5

Borough Public Works O&M Manual & Employee Training Program

AMBLER BOROUGH STORM WATER FACILITY OPERATION, MAINTENANCE, INSPECTION AND REPAIR MANUAL

INTRODUCTION

The Borough maintains a National Pollution Discharge Elimination System (NPDES) Phase II Municipal Separate Storm Sewer System (MS4) Permit. This manual is intended to fulfill the Pollution Prevention and Good Housekeeping for Municipal Operations and Maintenance Requirements, Minimum Control Measure No. 6 (MCM#6), of the Borough's NPDES Permit. The purpose of MCM#6 is to provide a pollution prevention/good housekeeping program (P2 Program) for municipal operations to minimize storm water impacts from the Borough storm sewer system. This manual focuses on the following items.

- Inspection, operation, maintenance and repair of municipally-owned storm water facilities
- Pollution prevention related to municipal vehicle operations

The NPDES Phase II MS4 Permit is a five-year program. During Year 1 baseline information on the storm water facilities of the Borough was collected. During Year 2 the Borough has established an operations and maintenance program for all Borough-owned storm system facilities and other BMPs. The program includes a detailed schedule for inspecting all storm water facilities, and for their operation and maintenance. This manual has been developed as part of the Year 2 requirements. During the remainder of the permit term (Years 3, 4, and 5) all Borough-owned facilities will be inspected at least annually to ensure they are meeting design criteria and are properly maintained and functional.

STORM WATER FACILITIES

The Borough storm water control facilities include channels, drainage swales, culverts, pipes and inlets or catch basins. The operation, maintenance, inspection and repair of each of these facilities are described below. Generally, all storm water control facilities are to be inspected annually and after each storm event. Any storm water control facility that appears to not function properly is to be brought to the attention of the Borough Engineer.

Channels and Drainage Swales

Inspections of channels and drainage swales are to occur annually and after each storm event. Repairs are to be completed on an as needed basis. Repairs may include, but are not limited to, reconstruction of channels and swales, replacement of lining material, removal of sediment and other debris. Sediment and debris removed must be managed properly.

Culverts and Pipes

Inspections of culverts and pipes, including culvert head and endwalls, are to occur annually and after each storm event. Repairs are to be completed on an as needed basis. Repairs may include, but are not limited to, replacement or slip lining of existing culverts and pipes, removal of sediment and other debris and reconstruction of headwalls and endwalls. If partial or full blockage of a culvert or pipe is suspected, the culvert or pipe should be inspected using remote video or other appropriate methods. Sediment and debris removed must be managed properly.

Inlets or Catch Basins

Inlets or catch basins are to be inspected annually and after each storm event. The condition of the inlet grate and inlet top is to be examined. Debris is to be removed from grates and inlet openings. Damaged grates and inlet tops are to be repaired or replaced. If needed, pargeting and re-bricking of inlets is to occur. If the depth of deposits within the inlet is greater than or equal to one-third the depth from the inlet bottom to the invert of the lowest pipe or opening into or out of the inlet (EPA, 1999), the inlet is to be cleaned as soon as possible. Inspect catch basins in which debris significantly exceeds the one-third depth standard twice annually. Sediment and debris removed must be managed properly.

VEHICLE OPERATIONS

This section of the manual provides information on proper Borough vehicle operations, in particular vehicle maintenance, fueling, and washing. Borough employees are to be aware of the following.

- frequency of activities
- types of substances used
- materials storage
- handling, and disposal practices
- employee training

The Borough should provide the following materials in Borough garages, workshops, vehicles where appropriate and any other Borough property where vehicle maintenance, fueling, and washing occurs.

- Dry absorbent material (e.g., kitty litter, straw or sawdust) for cleaning up spills
- Appropriate receptacles for disposal of oily rags, used filters, batteries, spent coolants, degreasers, etc.
- Drip pans for fluid collection and recycling
- Covered or pervious (e.g., gravel or grass) washing areas
- Signs that remind employees of pollution prevention and good housekeeping practices

The practices outlined below are to be followed in order to prevent non-storm water from entering the storm sewer system.

Fueling

- Place overfill prevention equipment on Underground Storage Tanks (USTs). Watch the transfer constantly to prevent overfilling and spilling
- Discourage “topping off” of fuel tanks through training and posting signs
- Avoid cleaning fueling areas with running water. Consider using a damp cloth on the pumps and a damp mop on the pavement rather than a hose
- Control spills immediately. Small spills can be cleaned up with rags and larger spills can be cleaned with dry absorbent material such as straw or sawdust. **Do not wash petroleum spills into the storm drain**

Maintenance

- Make proper disposal of greasy rags, oil filters, batteries, spent coolant, degreasers, etc. easy by providing appropriate receptacles. Locate waste and recycling drums in properly controlled areas off the yard, preferably areas with a concrete slab and secondary containment
- Avoid hosing down work areas
- Put leaking vehicles coming in for service under cover or immediately place drip pans under them
- Collect leaking or dripping fluids in drip pans or containers
- Keep a drip pan under the vehicle while you unclip hoses, unscrew filters, or remove other parts
- Do not pour liquid waste into floor drains, sinks, outdoor storm drain inlets, or other storm drains or sewer connections
- Place oil filters in a funnel over the waste oil recycling or disposal collection tank to drain excess oil before disposal, then crush and recycle oil filters; ask your oil supplier or recycler about recycling oil filters

Washing

- If possible, utilize commercial car washes. They typically recycle washwater or direct it to a wastewater treatment plant
- Create and use designated cleaning areas, preferably indoors where wash wastewater can be recycled or directed to treatment. If indoor washing is not possible, create specific areas to wash cars on gravel, grass, or other permeable surfaces
- Block off storm drains while washing or use an insert to catch wash water. Make inserts and dams available
- Convert to use of phosphate-free biodegradable detergents
- Pump soapy water from car washes into a sanitary sewer drain. If pumping into a drain is not feasible, pump car wash water onto grass or landscaping to provide filtration

- Be sure to check state and federal requirements regarding use of the sanitary sewer system

TRAINING

As part of the operations outlined in this manual the Borough must conduct basic awareness training of all municipal employees regarding storm water management and ensure that employees understand the procedures developed in this manual. The Borough must also establish a basic level of awareness of storm water issues among municipal employees, especially those in management and those responsible for implementing the procedures outlined in the is manual.

INSPECTION CHECKLISTS

Inspection checklists are included with this manual to aid in the inspection of storm water facilities and the maintenance and fueling of Borough vehicles.

Attachment 6

MS-4 Outfall Map – Last revised May 10, 2016

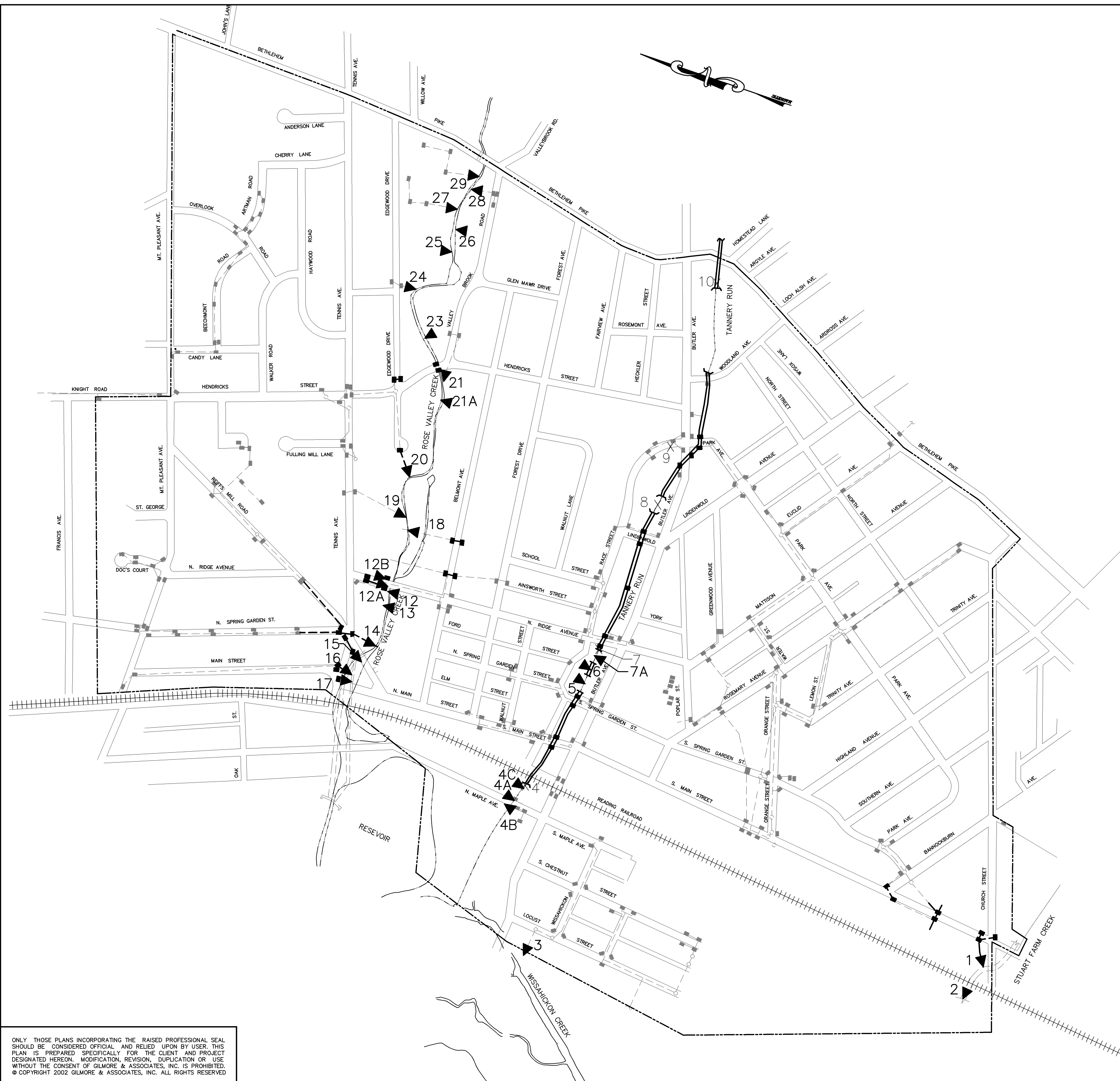

- REFERENCES:**
1. GENERAL PLAN OF THE STORM SEWERS OF THE BOROUGH OF AMBLER, MONTGOMERY COUNTY, 1984.

- NOTES:**
1. OUTFALLS 14 AND 21A WERE ADDED TO MAP 2005.
 2. OUTFALL 9 WAS FOUND AND WAS NOT OBSERVED.
 3. OUTFALLS 04, 07, 08 AND 10 HAVE BEEN INCORRECTLY IDENTIFIED AS OUTFALLS (05-25-07).
 4. OUTFALLS 4A AND 4B WERE ADDED TO MAP (01-31-07).
 5. OUTFALLS 4C, 7A, 12A AND 12B WERE ADDED TO MAP (05-25-07).

ONLY THOSE PLANS INCORPORATING THE RAISED PROFESSIONAL SEAL SHOULD BE CONSIDERED OFFICIAL AND RELIED UPON BY USER. THIS PLAN IS PREPARED SPECIFICALLY FOR THE CLIENT AND PROJECT DESIGNATED HEREON. MODIFICATION, REVISION, DUPLICATION OR USE WITHOUT THE CONSENT OF GILMORE & ASSOCIATES, INC. IS PROHIBITED.
 © COPYRIGHT 2002 GILMORE & ASSOCIATES, INC. ALL RIGHTS RESERVED

OWNER: AMBLER BOROUGH 122 EAST BUTLER AVENUE AMBLER, PA 19002 (215) 646-1000		REV.:	DESCRIPTION	DATE	BY	
MUNICIPAL FILE NO.: 2003-0122		TAX MAP PARCEL NO.: N/A	STORM SEWER OUTFALL MAP AMBLER BOROUGH MONTGOMERY COUNTY, PENNSYLVANIA GILMORE & ASSOCIATES, INC. CONSULTING ENGINEERS & LAND SURVEYORS 350 EAST BUTLER AVENUE, NEW BRITAIN, PA 18901-5106 (215) 345-4330 184 WEST MAIN STREET, SUITE 300, TRAPPE, PA 17420 (717) 493-4343 220 GALE LANE, KENNETT SQUARE, PA 19348 (610) 444-9006 953 ROUTE 202 NORTH, BRANCHBURG, NJ 08878 (908) 707-0002			
DATE: 05-25-07		TOTAL AREA: N/A				TOTAL LOTS: N/A
SCALE: 1"=300'						
		DESIGNED BY: DRAWN BY: SFM		CHECKED BY: JPD		
		JOB NO.: 03-0122		SHEET NO.: 1 OF 1		